

HEXAGON HEAD SCREWS

DIN 933

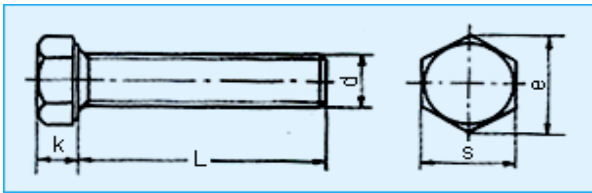

STRENGTH GRADE
8.8
10.9
12.9

mm

Thread size	M4	M5	M6	M8	M10	M12	M14	M16	M18	M20	M22	M24	M27	M30	
Pitch	0.7	0.8	1	1.25	1.5	1.75	2	2	2.5	2.5	2.5	3	3	3.5	
k	2.8	3.5	4	5.3	6.4	7.5	8.8	10	11.5	12.5	14	15	17	18.7	
e	Grade A	7.66	8.79	11.05	14.38	18.9	21.1	24.49	26.75	30.14	33.53	35.72	35.98	45.2	50.85
	Grade B	-	8.63	10.89	14.2	18.72	20.88	23.91	26.17	29.56	32.95	35.03	39.55	45.2	50.85
S	7	8	10	13	17	19	22	24	27	30	32	36	41	46	
L	8-40	8-40	8-50	12-60	16-60	20-80	25-80	30-100	30-100	40-100	50-100	50-100	60-100	70-100	

HEXAGON HEAD SCREWS

DIN 558

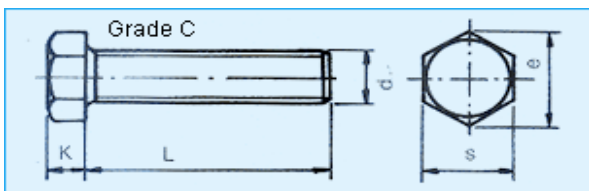

STRENGTH GRADE
8.8

mm

Thread size	M5	M6	M8	M10	M12	M16	M20	M24	M30	M36
Pitch	0.8	1	1.25	1.5	1.75	2	2.5	3	3.5	4
k	3.5	4	5.3	6.4	7.5	10	12.5	15	18.7	22.5
e	8.63	10.89	14.2	18.72	20.88	26.17	32.95	39.55	50.85	60.79
S	8	10	13	17	19	24	30	36	46	55
L	10-40	12-50	16-65	16-80	20-100	25-100	30-100	35-100	40-100	50-100

HEXAGON HEAD SCREWS

ISO 4017

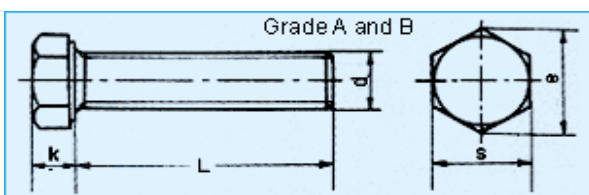

STRENGTH GRADE
8.8
10.9
12.9

mm

Thread size	M5	M6	M8	M10	M12	M16	M20	M24	M30	M36
Pitch	0.8	1	1.25	1.5	1.75	2	2.5	3	3.5	4
k	3.5	4	5.3	6.4	7.5	10	12.5	15	18.7	22.5
e	Grade A	8.79	11.05	14.38	17.77	20.03	26.75	33.53	39.98	-
	Grade B	-	-	-	-	-	26.17	32.95	39.55	50.85
S	8	10	13	16	18	24	30	36	46	55
L	8-40	8-50	12-60	16-60	20-80	30-100	40-100	50-100	70-100	80-100

HEXAGON HEAD BOLTS

DIN 931

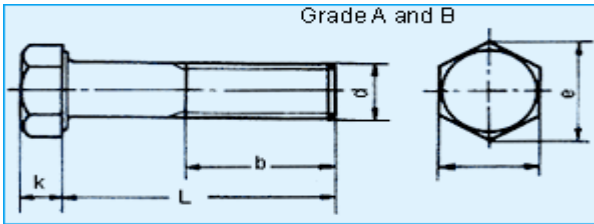

STRENGTH GRADE
8.8
10.9
12.9

mm

Thread size	M4	M5	M6	M8	M10	M12	M14	M16	M18	M20	M22	M24	M27	M30	
Pitch	0.7	0.8	1	1.25	1.5	1.75	2	2	2.5	2.5	2.5	3	3	3.5	
b	L ≤ 125	14	16	18	22	26	30	34	38	42	46	50	54	60	66
	125 < L ≤ 200	-	22	24	28	32	36	40	44	48	52	56	60	66	72
	L > 200	-	-	-	-	45	49	53	57	61	65	69	73	79	85
k	2.8	3.5	4	5.3	6.4	7.5	8.8	10	11.5	12.5	14	15	17	18.7	
e	A	7.66	8.79	11.05	14.38	18.9	21.1	24.49	26.75	30.14	33.53	35.72	39.98	45.2	50.85
	B	-	8.63	10.89	14.20	18.72	20.88	23.91	26.17	29.56	32.95	35.03	39.55	45.2	50.85
S	7	8	10	13	17	19	22	24	27	30	32	36	41	46	
L	25-40	25-50	30-60	35-80	40-100	45-120	50-140	55-160	65-180	65-200	70-220	80-240	90-260	90-300	

HEXAGON HEAD BOLTS

DIN 601

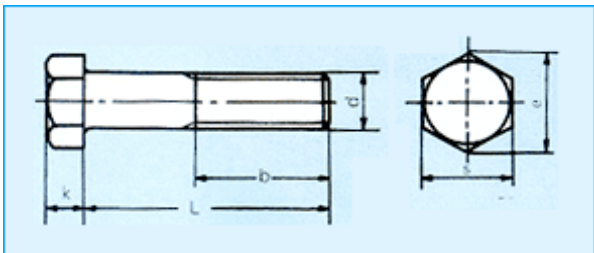

STRENGTH GRADE
4.8

mm

Thread size	M5	M6	M8	M10	M12	M16	M20	M24	M27	M30	M36
Pitch	0.8	1	1.25	1.5	1.75	2	2.5	3	3	3.5	4
b	L ≤ 125	16	18	22	26	30	38	46	54	60	78
	125 < L ≤ 200	22	24	28	32	36	44	52	60	66	84
	L > 200	35	37	41	45	49	57	65	73	79	97
k	3.5	4	5.3	6.4	7.5	10	12.5	15	17	18.7	22.5
e	8.63	10.89	14.2	18.72	20.88	26.17	32.95	39.55	45.2	50.85	60.79
S	8	10	13	17	19	24	30	36	41	46	55
L	25-50	30-60	35-80	40-100	45-100	55-100	65-200	80-240	90-300	90-300	110-300

HEXAGON HEAD BOLTS

ISO 4014

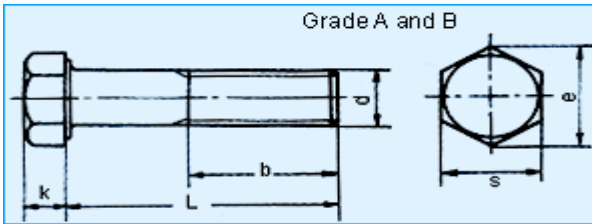

STRENGTH GRADE
8.8
10.9
12.9

mm

Thread size	M5	M6	M8	M10	M12	M16	M20	M24	M30	M36+
Pitch	0.8	1	1.25	1.5	1.75	2	2.5	3	3.5	4
b	L ≤ 125	16	18	22	26	30	38	46	54	66
	125 < L ≤ 200	-	-	-	-	-	44	52	60	72
	L > 200	-	-	-	-	-	-	-	73	85
k	3.5	4	5.3	6.4	7.5	10	12.5	15	18.7	22.5
e	Grade A	8.79	11.05	14.38	17.77	20.03	26.75	33.53	39.98	-
	Grade B	-	-	-	-	-	26.17	32.95	39.56	50.85
S	8	10	13	16	18	24	30	36	46	55
L	25-50	30-60	35-80	40-100	45-120	55-160	65-200	80-240	90-300	110-300

HEXAGON BOLTS WITH HEXAGON NUT

DIN 7990

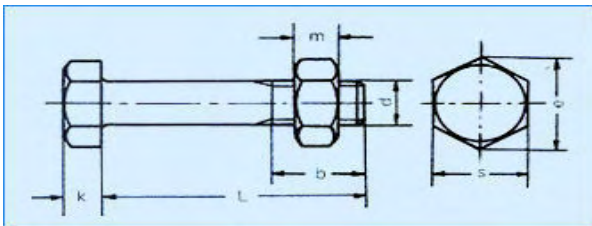

STRENGTH GRADE
10.9

mm

d1	M12	M16	M20	M22	M24	M27	M30
d	17.75	21	23.5	25.5	26	29	30.5
e	20.88	26.17	32.95	35.03	39.55	45.20	50.85
k	8	10	13	14	15	17	19
m	10	13	16	18	19	22	24
s	19	24	30	32	36	41	46
L	30-120	35-150	40-175	40-200	45-200	60-200	80-200

HEXAGON BOLTS WITH LARGE WIDTHS ACROSS FLATS

DIN 6914

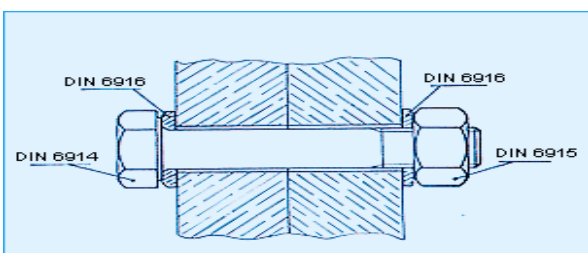

STRENGTH GRADE
10.9

mm

DIN6914	Diameter d	M12-M30	Length L	30-200
DIN 6915 Nuts	Diameter D	M12-M30	-	-
Washers	Diameter d	M13-M31	-	-

HEX FLANGE BOLTS & SCREWS

DIN 6921

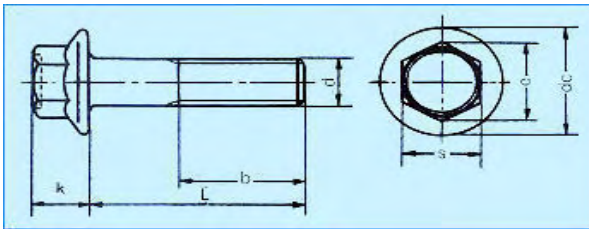

STRENGTH GRADE
4.8
8.8

mm

Thread size	M5	M6	M8	M10	M12	M14	M16	M20
Pitch	0.8	1	1.25	1.5	1.75	2	2	2.5
b	L ≤ 125	16	18	22	26	30	34	38
	125 < L ≤ 200	-	-	28	32	36	40	44
	L > 200	-	-	-	-	-	-	57
dc	11.8	14.2	18	22.3	26.6	30.5	35	43
k	5.4	6.6	8.1	9.2	11.5	12.8	14.4	17.1
e	8.71	10.95	14.26	16.5	17.62	19.86	23.15	29.87
S	8	10	13	15	16	18	21	27
L	oct-50	dic-60	16-80	20-100	25-120	30-140	35-160	40-200

MUSHROOM HEAD SQUARE NECK BOLTS

DIN 603

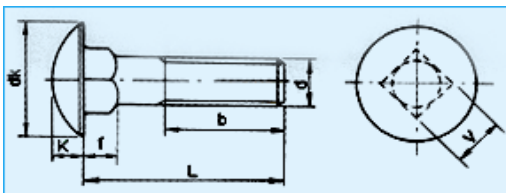

STRENGTH GRADE
4.8
8.8

mm

Thread size	M6	M8	M10	M12
Pitch	1	1.25	1.5	1.75
b	L ≤ 125	18	22	30
	125 < L ≤ 200	24	28	36
	L > 200	-	41	49
dk	16.55	20.65	24.65	30.65
f	4.6	5.6	6.6	8.75
k	3.88	4.88	5.38	6.95
v	6.48	8.58	1.58	12.7
L	16-80	20-100	20-100	30-100

HEXAGON SOCKET SET SCREWS WITH FLAT POINT

DIN 913

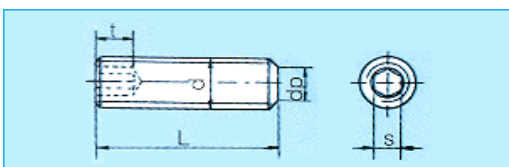

mm

Thread size	M3	M4	M5	M6	M8	M10	M12	M16	M20
dp	2	2.5	3.5	4	5.5	7	8.5	12	15
s	1.5	2	2.5	3	4	5	6	8	10
t	1.2	1.5	2	2	3	4	4.8	6.4	8
L	4-16	5-20	6-25	8-30	10-40	12-50	16-60	20-60	25-60

HEXAGON SOCKET SET SCREWS WITH CONE POINT

DIN 914

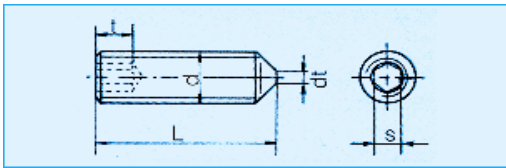

mm

Thread size	M3	M4	M5	M6	M8	M10	M12	M16	M20
dt	-	-	-	1.5	2	2.5	3	4	5
s	1.5	2	2.5	3	4	5	6	8	10
t	1.2	1.5	2	2	3	4	4.8	6.4	8
L	5-16	6-20	8-25	10-30	12-40	16-50	20-60	25-60	30-60

HEXAGON SOCKET SET SCREWS WITH DOG POINT

DIN 915

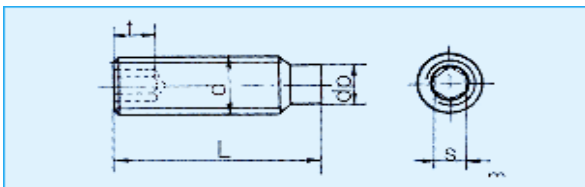

mm

Thread size	M3	M4	M5	M6	M8	M10	M12	M16	M20
dp	2	2.5	3.5	4	5.5	7	8.5	12	15
s	1.5	2	2.5	3	4	5	6	8	10
t	1.2	1.5	2	2	3	4	4.8	6.4	8
Z	short	0.75	1	1.25	1.5	2	2.5	3	4
	Long	1.5	2	2.5	3	4	5	6	8
L	6-16	8-20	10-25	14-30	16-40	20-50	25-60	30-60	35-60

HEXAGON SOCKET SET SCREWS WITH CUP POINT

DIN 916

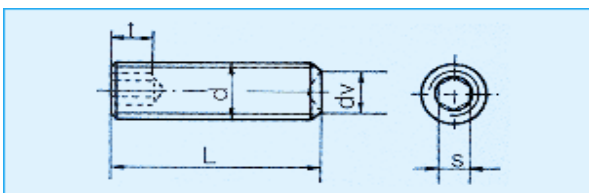

mm

Thread size	M3	M4	M5	M6	M8	M10	M12	M16	M20
dv	1.4	2	2.5	3	5	6	8	10	14
s	1.5	2	2.5	3	4	5	6	8	10
t	1.2	1.5	2	2	3	4	4.8	6.4	8
L	4-16	5-20	6-25	8-30	10-40	12-50	16-60	20-60	25-60

HEXAGON SOCKET HEAD CAP SCREWS

DIN 912

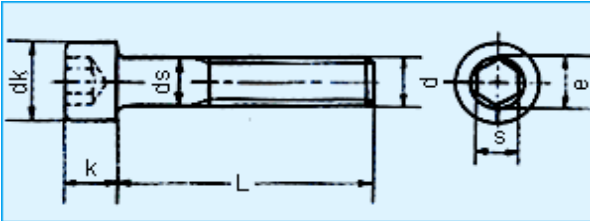

STRENGTH GRADE
8.8
10.9
12.9

mm

Thread size	M3	M4	M5	M6	M8	M10	M12	M14	M16	M20
pitch	0.5	0.7	0.8	1	1.25	1.5	1.75	2	2	2.5
dk	5.32	6.78	8.28	9.78	12.73	15.73	17.73	20.67	23.67	29.67
ds	3	4	5	6	8	10	12	14	16	20
k	2.86	3.82	4.82	5.7	7.64	9.64	11.57	13.57	15.57	19.48
e	2.87	3.44	4.58	5.72	6.86	9.15	11.43	13.72	16	19.44
s	2.5	3	4	5	6	8	10	12	14	17
L	5-30	6-40	8-50	10-60	12-80	16-100	20-120	25-140	25-160	30-200

HEXAGON SOCKET COUNTERSUNK HEAD CAP SCREWS

DIN 7991

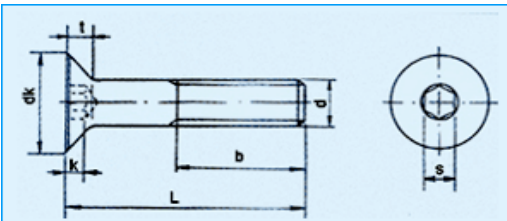

mm

Thread size	M3	M4	M5	M6	M8	M10	M12	M16	M20	
b	L < 125	12	14	16	18	22	26	30	38	46
	125 < L ≤ 200				24	28	32	36	44	52
	L > 200						45	49	57	65
dk	6	8	10	12	16	20	24	30	36	
k	1.70	2.30	2.80	3.30	4.40	5.50	6.50	7.50	8.50	
s	2.00	2.50	3.00	4.00	5.00	6.00	8.00	10.0	12.0	
t	0.95	1.55	2.05	2.25	3.20	4.10	4.30	5.00	5.60	
L	8-30	8-40	10-50	12-50	16-60	20-70	25-70	35-90	40-100	

TURNBUCKLE WITH HOOK AND EYE

DIN 1480

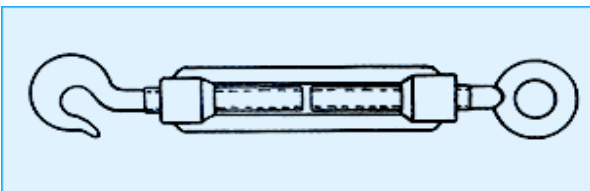

mm

SIZE AVAILABLE										
THREAD SIZE	6X10	8X110	5	5	0	0	0	0	5	5

LIFTING EYE BOLTS

DIN 580

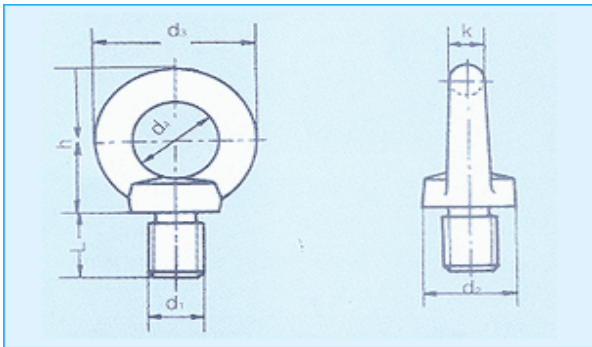

mm

d1	M8	M10	M12	M16	M20	M24	M30	M36
d2	20	25	30	35	40	50	65	75
d3	36	45	54	63	72	90	108	128
d4	20	25	30	35	40	50	60	70
h	36	45	53	62	71	90	109	128
k	8	10	12	14	16	20	24	28
L	13	17	20.5	27	30	36	45	54

EYE BOLTS

DIN 444

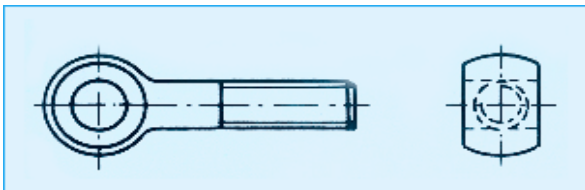

mm

Thread size	M5	M6	M8	M10	M12	M16	M20	M24	M30
Length	30-50	30-60	40-80	50-100	60-120	60-150	65-200	80-200	90-300

ANCHOR BOLTS

DIN 529



mm

Thread size	M8	M10	M12	M16	M20	M24	M30
Length	80-125	111-160	125-180	140-200	160-250	320	200-400

WELD SCREWS

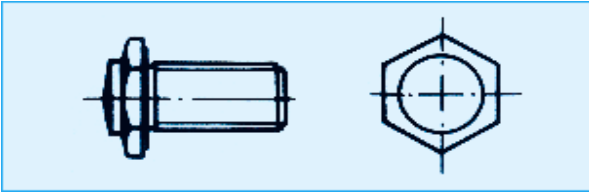

Thread size	M8×19
-------------	-------

DRAW BOLTS



size	1/4-20 × 3-1/2	1/4-20 × 4
------	----------------	------------

ACOUSTICAL TOGGLES

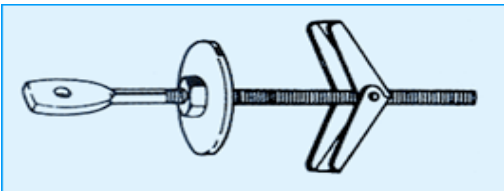

size	1/4-20 × 4-1/4
------	----------------

HEXAGON NUTS

DIN 934

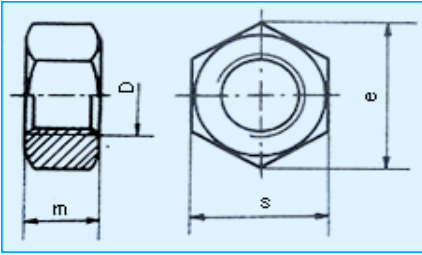

mm

Thread size	M2	M3	M4	M5	M6	M8	M10	M12	M16
Pitch	0.4	0.5	0.7	0.8	1	1.25	1.5	1.75	2
m	1.6	2.4	3.2	4	5	6.5	8	10	13
e	4.32	6.01	7.66	8.79	11.05	14.38	18.9	21.1	16.75
s	4	5.5	7	8	10	13	17	19	24
Thread size	M20	M24	M30	M36	M42	M48	M56		
Pitch	2.5	3	3.5	4	4.5	5	5.5		
m	16	19	24	29	34	38	45		
e	32.95	39.55	50.85	60.79	71.3	82.6	93.56		
s	30	36	46	55	65	75	85		

HEXAGON NUTS

DIN 555

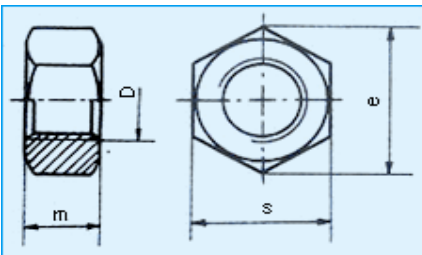

mm

Thread size	M5	M6	M8	M10	M12	M16	M20	M24	M30	M36	M42	M48	M56
Pitch	0.8	1	1.25	1.5	1.75	2	2.5	3	3.5	4	4.5	5	5.5
m	4	5	6.5	8	10	13	16	19	24	29	34	38	45
e	8.63	10.89	14.2	18.72	20.88	26.17	32.95	39.55	50.85	60.79	71.3	82.6	93.56
s	8	10	13	17	19	24	30	36	46	55	65	75	85

BRIGHT MILD STEEL HEX NUTS

B.S. 1083

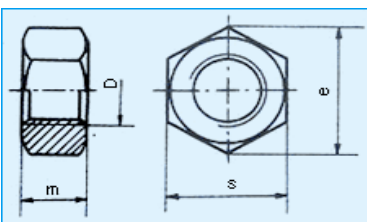

inches

Thread size	1/8	5/32	3/16	1/4	5/16	3/8	7/16	1/2
Pitch	40	32	24	20	18	16	14	12
s	5.59	7.6	8.23	11.30	13.34	15.24	18.03	20.83
e	6.40	8.20	9.50	13.00	15.30	17.50	20.70	24.10
m	3.04	3.88	4.24	5.08	6.35	7.92	9.53	11.10

HEXAGON NUTS

AS 1112

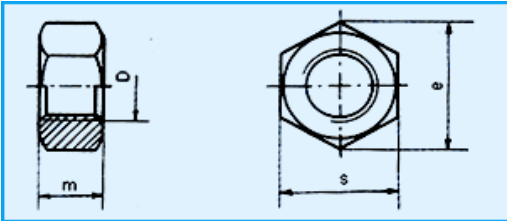

mm

Thread size	M2	M3	M4	M5	M6	M8	M10	M12	M16
Pitch	0.4	0.5	0.7	0.8	1.0	1.25	1.5	1.75	2.0
s	1.6	2.4	3.2	4.7	5.2	6.8	8.4	10.8	14.8
e	4.32	6.01	7.66	8.79	11.05	14.38	17.77	20.03	26.75
s	4	5.5	7	8	10	13	16	18	24
Thread size	M20	M24	M30	M36	M42	M48	M56		
Pitch	2.5	3.0	3.5	4.0	4.5	5.0	5.5		
s	18	21.5	25.6	31	34.8	38.8	45.8		
e	32.95	39.55	50.85	60.79	71.30	82.60	93.50		
s	30	36	46	55	65	75	85		

HEXAGON NUTS

B.S. 1768

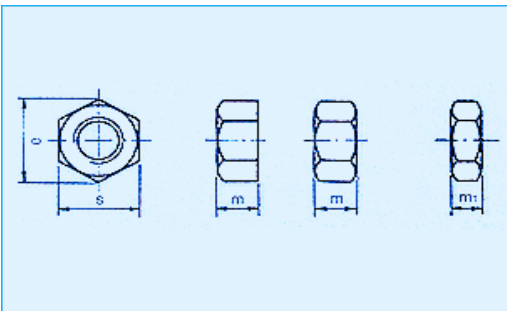

inches

Thread size	1/4	5/16	3/8	7/16	1/2	9/16	5/8	3/4	7/8
e	0.505	0.577	0.650	0.794	0.866	1.010	1.083	1.300	1.515
s	0.437	0.500	0.562	0.687	0.750	0.875	0.937	1.125	1.312
m	0.224	0.271	0.333	0.380	0.442	0.489	0.552	0.651	0.760
m1	0.286	0.333	0.411	0.458	0.567	0.614	0.724	0.822	0.916
m2	0.161	0.192	0.224	0.255	0.317	0.349	0.380	0.432	0.494
Thread size	1	1 1/8	1 1/4	1 3/8	1 1/2	1 3/4	2		
e	1.732	1.948	2.165	2.382	2.598	3.031	3.461		
s	1.500	1.687	1.875	2.062	2.250	2.625	3.000		
m	0.874	0.989	1.087	1.197	1.311	1.530	1.754		
m1	1.015	1.176	1.275	1.400	1.530	-	-		
m2	0.562	0.629	0.744	0.806	0.874	0.999	1.129		

HEXAGON NUTS

B.S. 1769

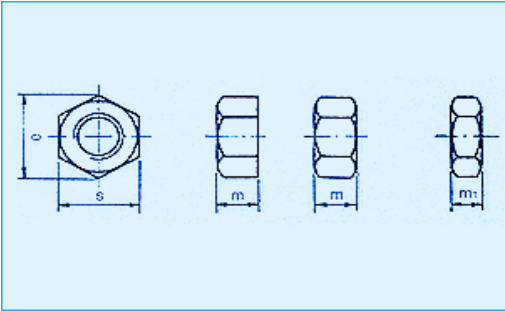

inches

Thread size	1/2	5/8	3/4	7/8	1	1 1/8	1 1/4	1 3/8	1 1/2	1 3/4	2
P UNC	13	11	10	9	8	7	7	6	6	5	4 1/2
P UNF	20	18	16	14	12	12	12	12	12	-	-
e	1.01	1.23	1.44	1.66	1.88	2.09	2.31	2.53	2.74	3.18	3.61
s	0.875	1.062	1.250	1.437	1.625	1.812	2.000	2.187	2.375	2.750	3.125
m	0.520	0.647	0.774	0.901	1.028	1.155	1.282	1.409	1.536	1.790	2.044
m1	0.332	0.397	0.462	0.526	0.590	0.655	0.782	0.846	0.911	1.040	1.169

HEXAGON NUTS

ISO 4032

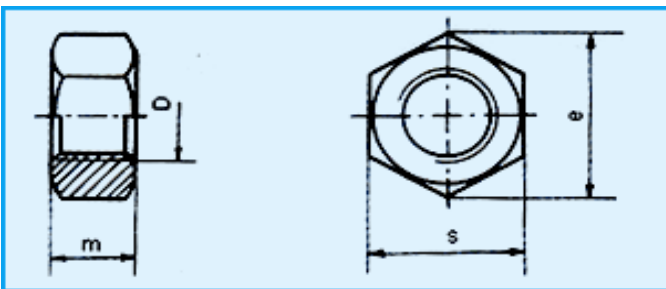

mm

Thread size	M2	M3	M4	M5	M6	M8	M10	M12	M16
Pitch	0.4	0.5	0.7	0.8	1	1.25	1.5	1.75	2
m	1.6	2.4	3.2	4.7	5.2	6.8	8.4	10.8	14.8
e	4.32	6.01	7.66	8.79	11.05	14.38	17.77	20.03	26.75
s	4	5.5	7	8	10	13	16	18	24
Thread size	M20	M24	M30	M36	M42	M48	M56		
Pitch	2.5	3	3.5	4	4.5	5	5.5		
m	18	21.5	25.6	31	34	38	45		
e	32.95	39.55	50.85	60.79	71.3	82.6	93.56		
s	30	36	46	55	65	75	85		

HEXAGON NUTS

ISO 4033

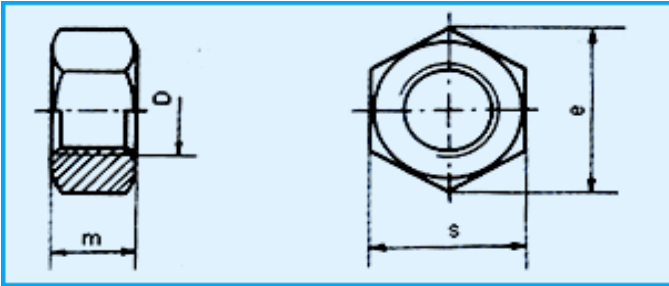

mm

Thread size	M5	M6	M8	M10	M12	M16	M20	M24	M30	M36
Pitch	0.8	1	1.25	1.5	1.75	2	2.5	3	3.5	4
m	5.1	5.7	7.5	9.3	12	16.4	20.3	23.9	28.6	34.7
e	8.79	11.05	14.38	17.77	20.03	26.75	32.95	39.55	50.85	60.79
s	8	10	13	16	18	24	30	36	46	55

HEXAGON NUTS

ISO 4034

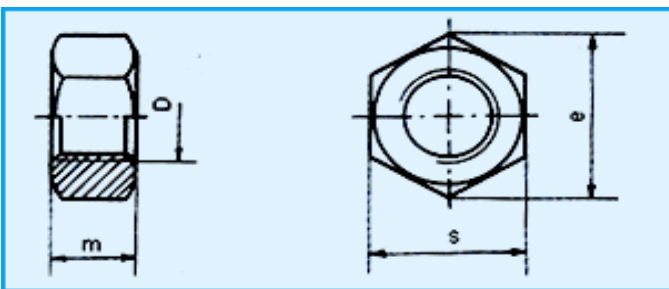

mm

Thread size	M5	M6	M8	M10	M12	M16	M20	M24	M30	M36
Pitch	0.8	1	1.25	1.5	1.75	2	2.5	3	3.5	4
m	5.6	6.1	7.9	9.5	12.2	15.9	19	22.3	26.4	31.5
e	8.63	10.89	14.20	17.59	19.85	26.17	32.95	39.55	50.85	60.79
s	8	10	13	16	18	24	30	35	45	53.8

HEXAGON THIN NUTS

ISO 4035

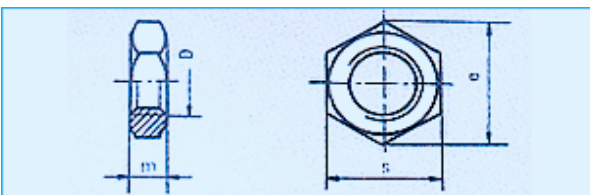

mm

Thread size	M10	M12	M14	M22
Pitch	1.5	1.75	2	2.5
m	5	6	7	11
e	17.77	20.03	23.35	37.29
s	16	18	21	24

BLACK MILD STEEL HEX NUTS

B.S. 916

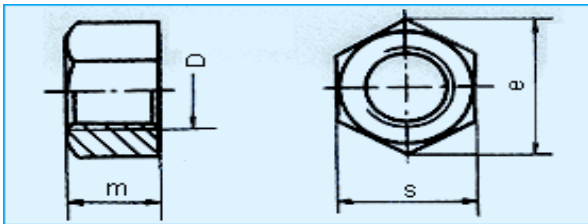

inches

Thread size	5/8	3/4	7/8	1	1 1/8	1 1/4	1 3/8	1 1/2	1 3/4	2
Thread per inch	11	10	9	8	7	7	6	6	5	4 1/2
s	25.65	30.48	33.02	37.59	42.42	47.24	52.07	56.39	65.53	70.10
e	29.50	35.10	38.00	43.20	48.80	54.30	59.90	64.90	75.40	80.60
m	14.78	17.96	19.81	23.00	26.16	29.59	32.76	35.94	42.55	45.72

HEXAGON NUTS

UNI 5587

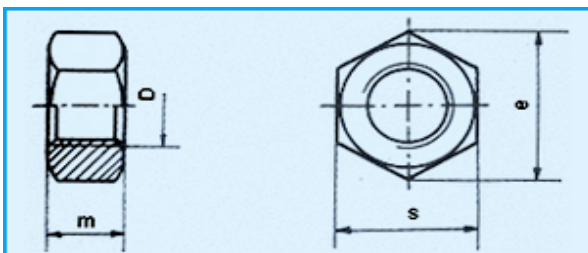

mm

Thread size	M3	M4	M5	M6	M8	M10	M12	M16	M20	M24	M30
m	3	4	5	6	8	10	12	16	20	24	30
e	6.08	7.74	8.87	11.05	14.38	18.90	21.10	26.75	33.53	39.98	51.29
s	5.5	7	8	10	13	17	19	24	30	36	46

CHAMFERED HEXAGON THIN NUTS

DIN 439

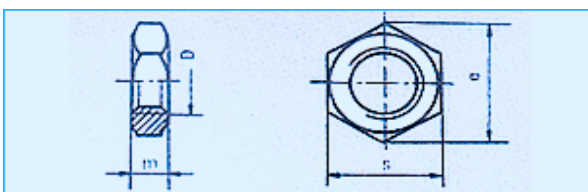

mm

Thread size	M3	M4	M5	M6	M8	M10	M12	M16	M20	M24	M30	M36	M42	M48
Pitch	0.5	0.7	0.8	1	1.25	1.5	1.75	2	2.5	3	3.5	4	4.5	5
m	1.8	2.2	2.7	3.2	4	5	6	8	10	12	15	18	21	24
e	6.01	7.66	8.79	11.05	14.38	18.9	21.1	26.75	32.95	39.55	50.85	60.79	71.3	82.6
s	5.5	7	8	10	13	17	19	24	30	36	46	55	65	75

HEXAGON THIN NUTS

DIN 936

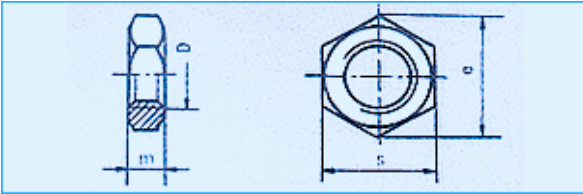

mm

Thread size	M8	M10	M12	M16	M20	M24	M30	M36	M42	M48
Pitch	1.25	1.5	1.75	2	2.5	3	3.5	4	4.5	5
m	5	6	7	8	9	10	12	14	16	18
e	14.38	18.90	21.1	26.75	32.95	39.55	50.85	60.79	71.3	82.6
s	13	17	19	24	30	36	46	55	65	75

ALL-METAL PREVALLING TORQUE TYPE HEXAGON NUTS

DIN 980

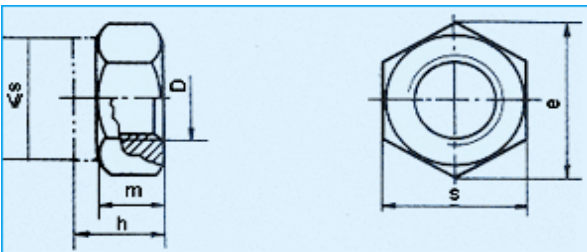

mm

Thread size	M5	M6	M8	M10	M12	M14	M16	M18	M20
Pitch	0.8	1	1.25	1.5	1.75	2	2	2.5	2.5
h	5.1	6	8	10	12	14	16	18	20
e	8.79	11.05	14.38	18.9	21.1	24.49	26.75	29.56	32.95
s	8	10	13	17	19	22	24	27	30

PREVALLING TORQUE TYPE HEXAGON THIN NUTS WITH NONMETALLIC INSERT

DIN 985

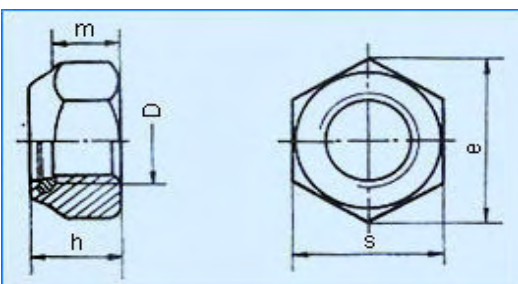

mm

Thread size	M5	M6	M8	M10	M12	M14	M16	M18	M20
Pitch	0.8	1	1.25	1.5	1.75	2	2	2.5	2.5
h	5	6	8	10	12	14	16	18.5	20
m	3.2	4	5.5	6.5	8	9.5	10.5	13	14
e	8.79	11.05	14.38	18.9	21.1	24.49	26.75	29.56	32.95
s	8	10	13	17	19	22	24	27	30

HEXAGON WELD NUTS

DIN 929

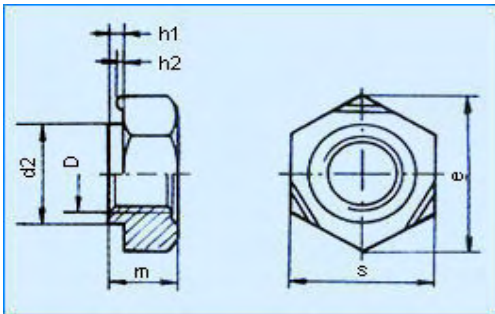

mm

Thread size	M4	M5	M6	M8	M10	M12	M16
m	3.5	4	5	6.5	8	10	13
e	9.83	10.95	12.02	15.38	18.74	20.91	26.51
s	9	10	11	14	17	19	24
h ₁	0.65	0.7	0.75	0.9	1.15	1.4	1.8
h ₂	0.35	0.4	0.4	0.5	0.65	0.8	1
d ₂	6	7	8	10.5	12.5	14.8	18.8

HEX CONNECTING NUTS

DIN 6334



Thread size	M6	M8	M10	M12	M16
-------------	----	----	-----	-----	-----

HEXAGON NUTS WITH FLANGE

DIN 6923

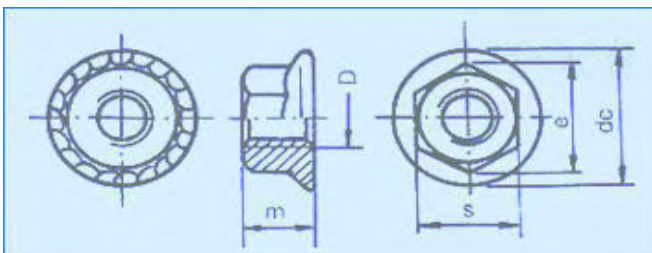

mm

Thread size	M5	M6	M8	M10	M12	M14	M16	M20
Pitch	0.8	1	1.25	1.5	1.75	2	2	2.5
m	5	6	8	10	12	14	16	20
e	8.79	11.05	14.38	16.64	20.03	23.36	26.75	32.95
s	8	10	13	15	18	21	24	30
dc	11.8	14.2	17.9	21.8	26	29.9	34.5	42.8

HEXAGON SLOTTED NUTS

DIN 935

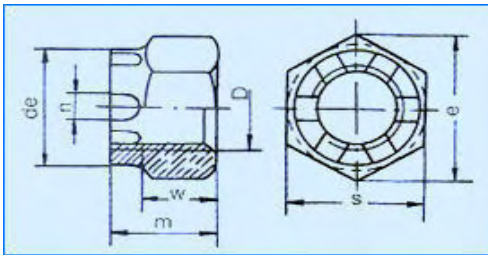

mm

Thread size	M6	M8	M10	M12	M16	M20	M24	M30	M36
m	7.5	9.5	12	15	19	22	27	33	38
e	11.05	14.38	17.77	20.03	26.75	32.95	39.55	50.85	60.79
s	10	13	16	18	24	30	36	46	55
n	2	2.5	2.8	3.5	4.5	4.5	5.5	7	7
w	5	6.5	8	10	13	16	19	24	29
de	-	-	-	16	22	28	34	42	50

HEXAGON THIN SLOTTED NUTS

DIN 937

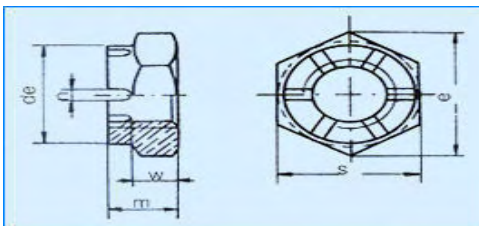

mm

Thread size	M6	M8	M10	M12	M16	M20	M24	M30	M36
m	6	8	9	10	12	13	15	18	20
e	11.05	14.38	18.9	20.1	26.75	32.95	35.55	50.85	60.79
s	10	13	17	19	24	30	36	46	55
n	2	2.5	2.8	3.5	4.5	4.5	5.5	7	7
w	3.5	4.5	5	6	7	8	9	11	13
de	-	-	-	17	22	28	33	41	49

HEXAGON THIN SLOTTED NUTS

DIN 979

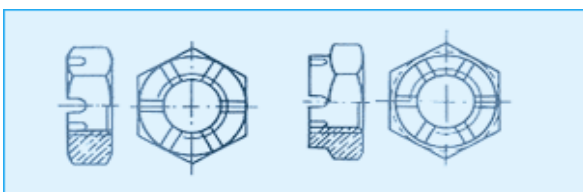

mm

Thread size	M6	M8	M10	M12	M16	M20	M24	M30	M36
m	5	6.5	8	10	13	16	19	24	29
e	11.05	14.38	17.77	20.03	26.75	32.95	39.55	50.85	60.79
s	10	13	16	18	24	30	36	46	55
n	2	2.5	2.8	3.5	4.5	4.5	5.5	7	7
w	2.5	3.5	4	5	7	10	11	15	20
de	-	-	-	16	22	28	34	42	50

HEXAGON CAP NUTS

DIN 917

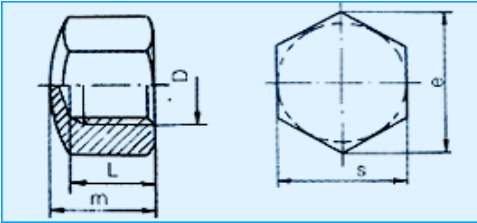

mm

Thread size	M4	M5	M6	M8	M10	M12	M16	M20	M24
m	5.5	7	9	12	14	16	20	25	30
e	7.66	8.79	11.05	14.38	17.77	20.03	26.75	32.95	39.55
s	7	8	10	13	16	18	24	30	36
L	4.16	4.96	6.71	9.21	10.65	13.15	16.65	20.58	23.58

HEXAGON DOMED CAP NUTS

DIN 986

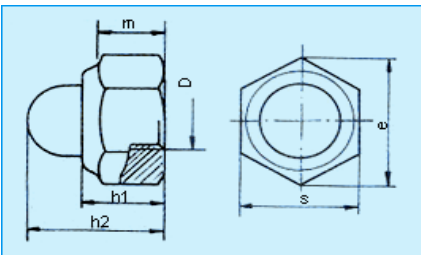

mm

Thread size	M4	M5	M6	M8	M10	M12	M16	M20
m	2.9	4.4	4.9	6.44	8.04	10.37	14.1	16.9
e	7.66	8.79	11.05	14.38	18.9	21.1	26.75	32.95
s	7	8	10	13	16	18	24	30
h ₁	5.6	6	7.5	8.9	10.5	13.5	16.5	21
h ₂	9.6	10.5	12	14	18.1	22.5	27.5	35

HEXAGON DOMED CAP NUTS

DIN 1587

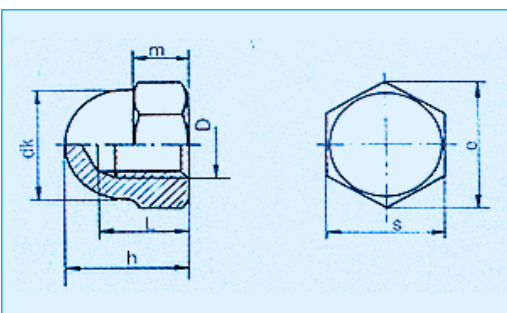

mm

Thread size	M4	M5	M6	M8	M10	M12	M16	M20	M24
m	3.2	4	5	6.5	8	10	13	16	19
e	7.66	8.79	11.05	14.38	17.77	20.03	26.75	33.53	39.98
s	7	8	10	13	16	18	24	30	36
h	8	10	12	15	18	22	28	34	42
L	5.26	7.21	7.71	10.65	12.65	15.65	20.58	25.58	30.5
dk	6.5	7.5	9.5	12.5	15	17	23	28	34

WING NUTS

DIN 315

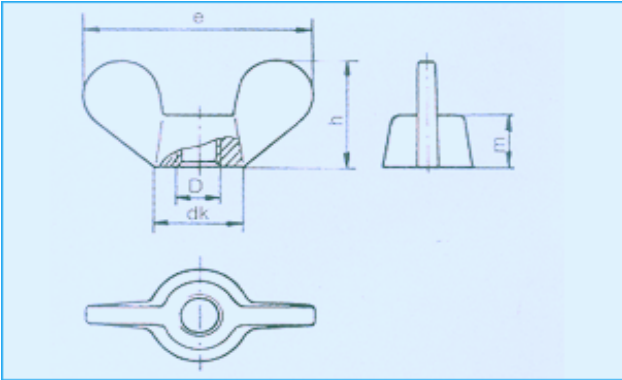

mm

Thread size	M4	M5	M6	M8	M10	M12	M16	M20	M24
Pitch	0.7	0.8	1	1.25	1.15	1.75	2	2.5	3
dk	6	8	10	13	17	20	26	32	41
e	18	24	30	36	48	62	70	86	106
h	8.5	11	15	18	23	31	35	44	53.5
m	3.2	4	5	6.5	8	10	13	16	20

SQUARE THIN NUTS

DIN 562

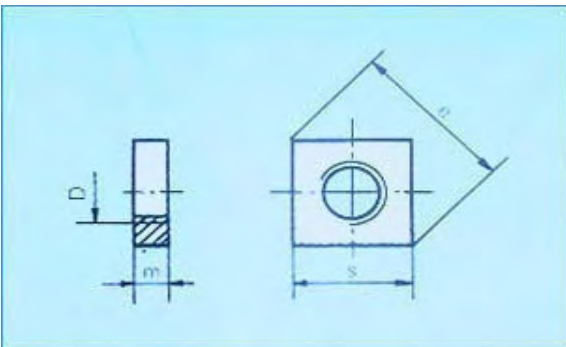

mm

Thread size	M2	M3	M4	M5	M6	M8	M10	
Pitch	0.4	0.5	0.7	0.8	1	1.25	1.5	
m	1.2	1.8	2.2	2.7	3.2	4	5	
e	5	7	8.9	10.2	12.7	16.5	20.2	21.5
S	4	5.5	7	8	10	13	16	17

SQUARE NUTS

DIN 928

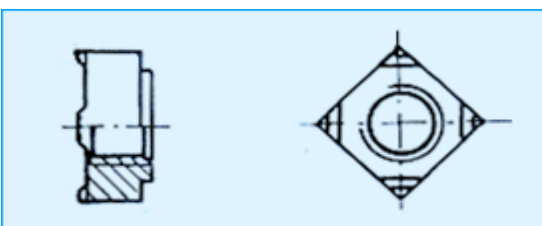

mm

Thread size	M4	M5	M6	M8	M10	M12
-------------	----	----	----	----	-----	-----

SQUARE NUTS

B.S.

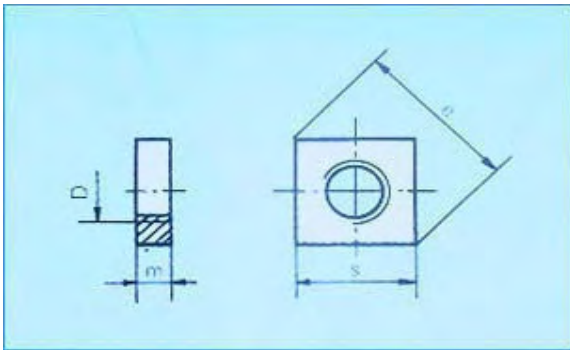

inches

Thread size	1/8	5/32	3/16	1/4
Thread per inch	40	32	24	20
m	2.13	2.74	3.12	3.38
e	7.9	10.1	11.6	15.9
s	5.59	7.16	8.23	11.30

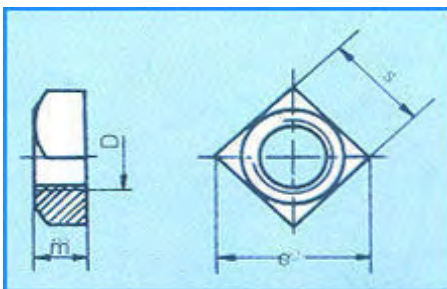

inches

Thread size	3/16	1/4	5/16	3/8	7/16	1/2
Thread per inch	24	20	18	16	14	12
m	4.24	5.08	6.35	7.92	9.53	11.10
e	11.6	15.9	18.9	21.5	25.4	29.4
s	8.23	11.3	13.34	15.24	18.03	20.83

SQUARE NUTS

DIN 557

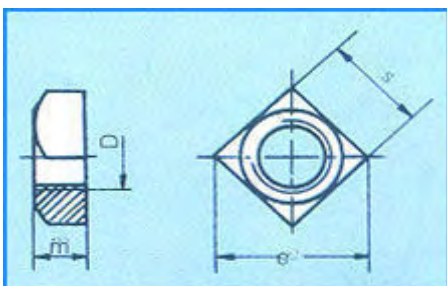

mm

Thread size	M5	M6	M8	M10	M12	M16	M20		
Pitch	0.8	1	1.25	1.5	1.75	2	2.5		
m	4	5	6.5	8	10	13	16		
e	11.3	14.1	18.4	22.6	24	25.4	26.9	32.9	42.4
s	8	10	13	16	17	18	19	24	30

TEE NUTS WITH PRONGES

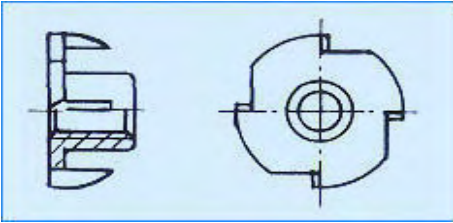

Thread size	M3	M4	M5	M6	M8	M10
-------------	----	----	----	----	----	-----

LOCK NUTS

DIN 7967

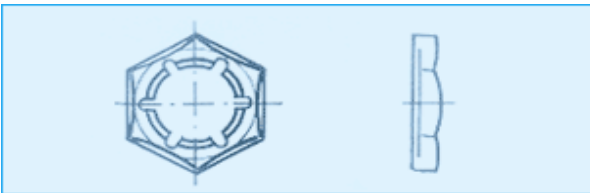

For thread	M3	M4	M5	M6	M8	M10	M12	M14	M16	M18
For thread	M20	M22	M24	M27	M30	M33	M36	M39	M42	

LOCK NUTS

DIN 582

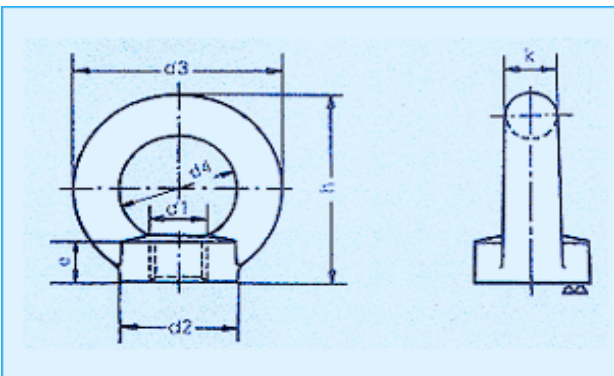

mm

d1	M8	M10	M12	M16	M20	M24	M30	M36
d2	20	25	30	35	40	50	65	75
d3	36	45	54	63	72	90	108	126
d4	20	25	30	35	40	50	60	70
e	8.5	10	11	13	16	20	25	30
h	36	45	53	62	71	90	109	128
k	8	10	12	14	16	20	24	28

EYE COUPLING NUTS

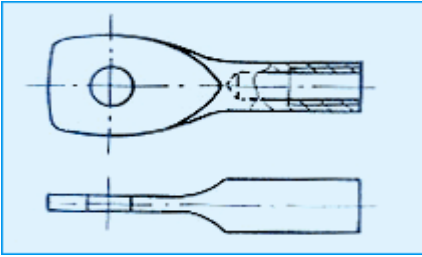

Thread size	M6
-------------	----

ANCHOR NUTS

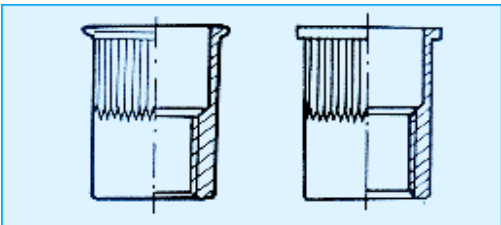

Thread size	M3	M4	M5	M6	M8	M10
-------------	----	----	----	----	----	-----

WASHERS (Grade A)

DIN 125

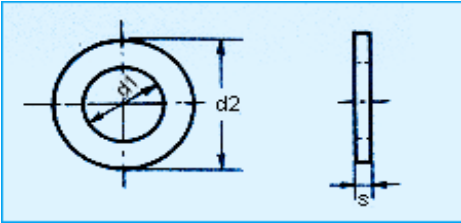

mm

d1	1.7	1.8	2.2	2.5	2.7	2.8	3.2	3.7	4.3	5.3	6.4
d2	4	4.5	5	6	6	7	7	8	9	10	12
s	0.3	0.3	0.3	0.5	0.5	0.5	0.5	0.5	0.8	1	1.6
d1	7.4	8.4	10.5	13	15	17	19	21	23	23	
d2	14	16	20	24	28	30	34	37	39	39	
s	1.6	1.6	2	2.5	2.5	3	3	3	3	3	

WASHERS (Grade C)

DIN 126

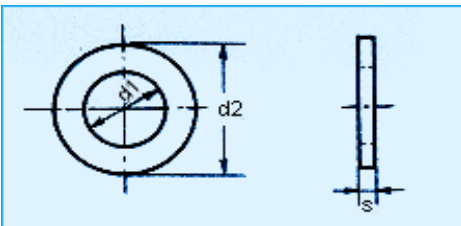

mm

d1	5.5	6.6	7.6	9	11	13.5	15.5	17.5	20	22	24
d2	10	12.5	14	16	20	24	28	30	34	37	39
s	1	1.6	1.6	1.6	2	2.5	2.5	3	3	3	3
d1	26	30	33	36	39	42	45	48	52	56	
d2	44	50	56	60	66	72	78	85	92	98	
s	4	4	4	5	5	6	7	7	8	8	

SQUARE BEVELED WASHERS

DIN 434

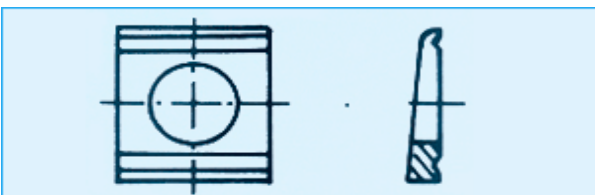

For screws	M8	M10	M12	M16	M20	M22	M24	M27
------------	----	-----	-----	-----	-----	-----	-----	-----

SQUARE BEVELED WASHERS

DIN 435

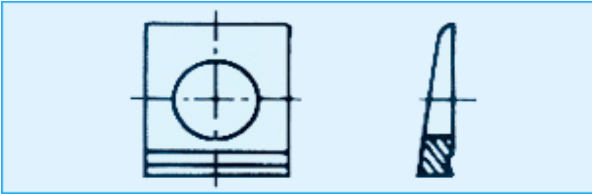

For screws	M8	M10	M12	M16	M20	M22	M24	M27	M30
------------	----	-----	-----	-----	-----	-----	-----	-----	-----

SPRING LOCK WASHERS

DIN 127

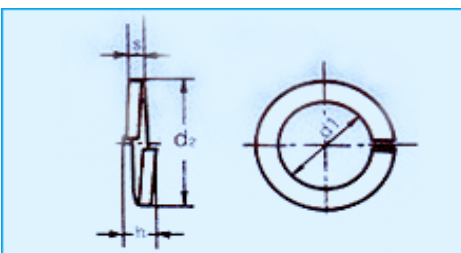

mm

Nominal size	3	3.5	4	5	6	7	8	10	12
d1	3.4	3.9	4.4	5.4	6.5	7.5	8.5	10.7	12.7
d2	6.2	6.7	7.6	9.2	11.8	12.8	14.8	18.1	21.1
h	1.9	1.9	2.1	2.8	3.8	3.8	4.7	5.2	5.9
s	0.8	0.8	0.9	1.2	1.6	1.6	2	2.2	2.5
Nominal size	14	16	18	20	22	24	27	30	
d1	14.7	17	19	21.2	23.5	25.5	28.5	31.7	
d2	24.1	27.4	29.4	33.6	35.9	40	43	48.2	
h	7.1	8.3	8.3	9.4	9.4	11.8	11.8	14.2	
s	3	3.5	3.5	4	4	5	5	6	

SPRING LOCK WASHERS

B.S.

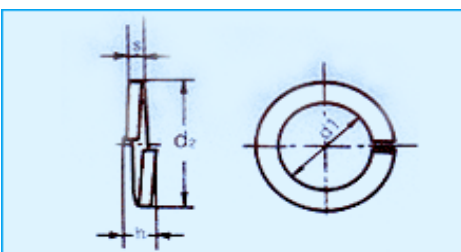

inches

Nominal	1/8	5/32	3/16	1/4	5/16	3/8	7/16	1/2	9/16
d1	0.133	0.164	0.196	0.266	0.328	0.391	0.453	0.516	0.601
b	0.053	0.061	0.075	0.108	0.130	0.142	0.161	0.173	0.189
h	0.067	0.083	0.098	0.142	0.165	0.189	0.220	0.244	0.283
s	0.033	0.041	0.049	0.071	0.083	0.094	0.110	0.122	0.142
Nominal	5/8	3/4	7/8	1	1 1/8	1 1/4	1 1/2		
d1	0.656	0.781	0.906	1.031	1.156	1.281	1.531		
b	0.213	0.248	0.276	0.291	0.307	0.331	0.354		
h	0.303	0.354	0.394	0.433	0.472	0.504	0.551		
s	0.152	0.177	0.197	0.217	0.236	0.252	0.276		

SPLIT PINS

DIN 94

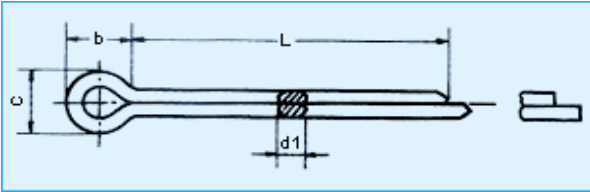

mm

Nominal	2	2.5	3.2	4	5	6.3	8	10
d1	1.8	2.3	2.9	3.7	4.6	5.9	7.5	9.5
b	4	5	6.4	8	10	12.6	16	20
c	3.2	4	5.1	6.5	8	10.3	13.1	16.6
L	10-40	12-50	18-80	20-125	20-125	28-140	36-140	56-140

SPLIT PINS

ISO 1234

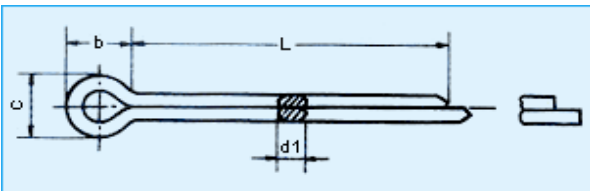

mm

Nominal	1	1.2	1.6	2	2.5	3.2	4	5	6.3	8	10
d1	0.8	0.9	1.3	1.7	2.1	2.7	3.5	4.4	5.7	7.3	9.3
b	3	3	3.2	4	5	6.4	8	10	12.6	16	20
c	1.8	2	2.8	3.6	4.6	5.8	7.4	9.2	11.8	15	19
L	6-20	8-20	8-20	10-20	12-50	18-80	20-80	20-80	28-80	36-80	56-80

COTTER PINS

B.S.

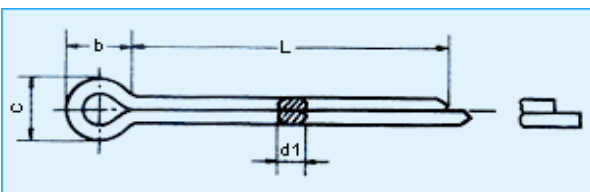

inches

Nominal	3/32	7/64	1/8	9/64	5/32	11/64	3/16	7/32	1/4	9/32	5/16	3/8
d1	2.11	2.57	2.70	3.36	3.51	4.09	4.40	5.29	5.69	6.86	6.29	9.10
b	4.83	5.59	6.35	7.11	7.87	8.64	9.65	11.18	12.7	14.22	15.75	19.05
c	4.72	5.48	6.29	7.11	7.87	8.68	9.44	11.07	12.64	14.22	15.97	18.94
L(in)	3/8-7/8	3/8-2	1/2-3	1/2-3	5/8-3	5/8-3	5/8-3	3/4-3	3/4-3	1 1/2-3	1 1/2-3	1 1/2-3

BLIND RIVET

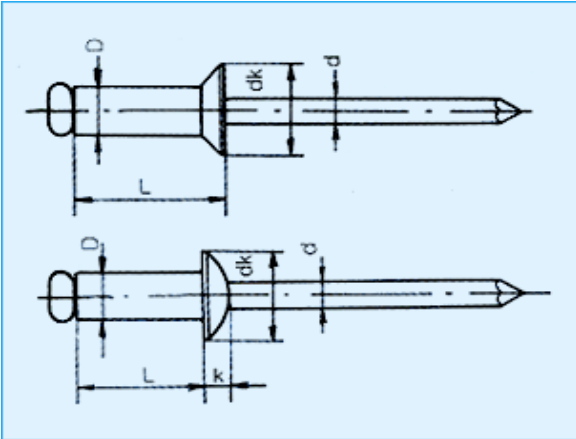

mm

Nominal	3	3.2	4	4.8	5
L	4.8-16	4.8-18	4.8-22	6.4-30	6.4-30
dk	6	6	8	9.5	9.5
k	1	1	1.4	1.5	1.5
d	1.8	1.8	2.2	2.6	2.8

SEALED TYPE ALUMINIUM BLIND RIVET

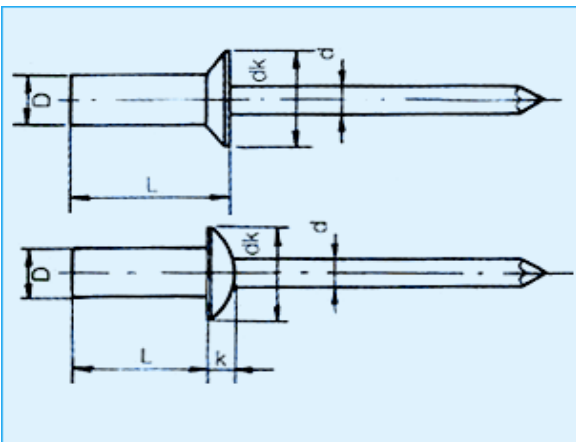

mm

Nominal	3.2	4	4.8	5
L	5-18	5-22	8-30	8-30
dk	6	8	9.5	9.5
k	1	1.4	1.5	1.5
d	1.7	2.2	2.64	2.8

BOLT ANCHORS

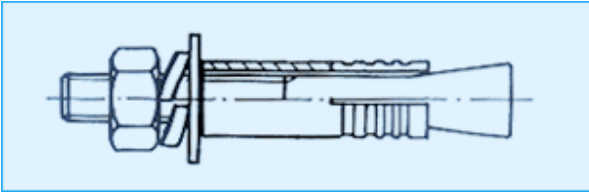

Thread size	M6	M8	M10	M12	M16	M20	M22	M24
-------------	----	----	-----	-----	-----	-----	-----	-----

CUT ANCHORS

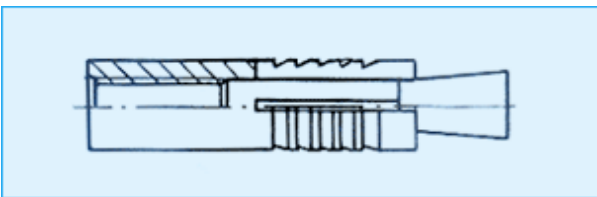

Thread size	M6	M8	M10	M12	M16	M20	M22
Length	30	35	40	52	63	83	93

mm

SLEEVE ANCHORS

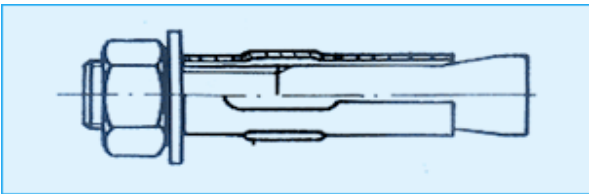

Nominal size	6.5	8	10	12	16	20
--------------	-----	---	----	----	----	----

mm

WEDGE ANCHORS

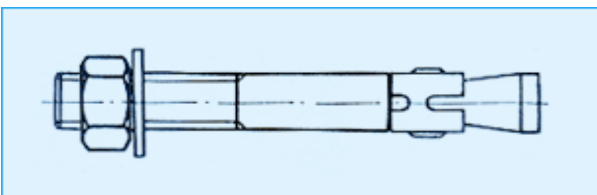

Thread size	M6	M8	M10	M12	M16	M20
Length	49-95	50-220	65-250	75-250	90-250	90-300

mm

TIE WIRE ANCHOR

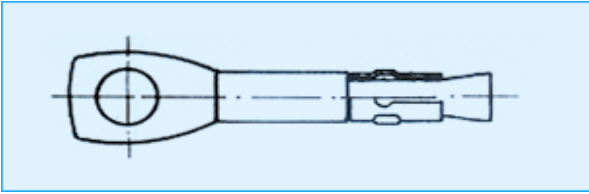

mm

Nominal size	6	6
L	60	67

DROP IN ANCHORS

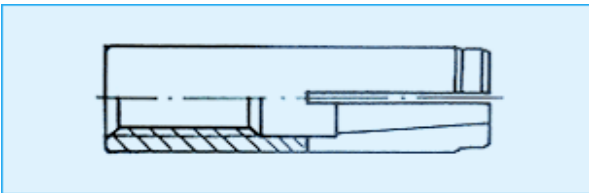

mm

Thread size	M6	M8	M10	M12	M16	M20
Length	25	30	40	50	65	80

HEAVY-DUTY SHELLANCHOR

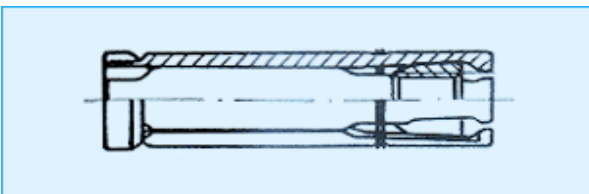

mm

Thread size	M6	M8	M10	M12	M16	M20
Length	45	55	60	75	115	130

NYLON HAMMER FIXING

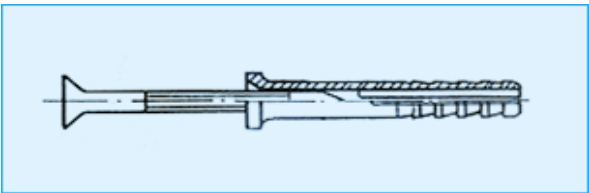

mm

Nominal size	5	6	8
Length	20-50	35-80	60-135

SLOTTED CHEESE HEAD SCREWS

DIN 84

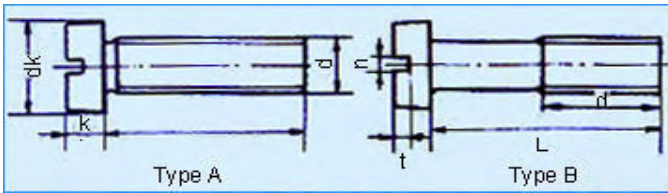

mm

Thread size	M3	M3.5	M4	M5	M6	M8	M10
dk	5.5	6	7	8.5	10	13	16
k	2	2.4	2.6	3.3	3.9	5	6
L	Type A	6-22	6-22	8-25	8-28	10-35	14-40
	Type B	25-30	25-35	28-40	30-50	40-60	45-80

SLOTTED PAN HEAD SCREWS

DIN 85

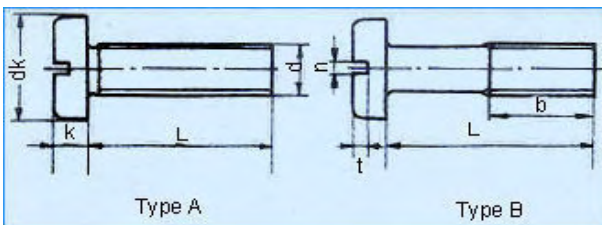

mm

Thread size	M3	M3.5	M4	M5	M6	M8	M10
dk	6	7	8	10	12	16	20
k	1.8	2.1	2.4	3	3.6	4.8	6
L	Type A	6-22	6-22	8-25	8-28	10-35	14-40
	Type B	25-30	25-35	28-40	30-50	40-60	45-80

SLOTTED COUNTERSUNK HEAD SCREWS

DIN 963

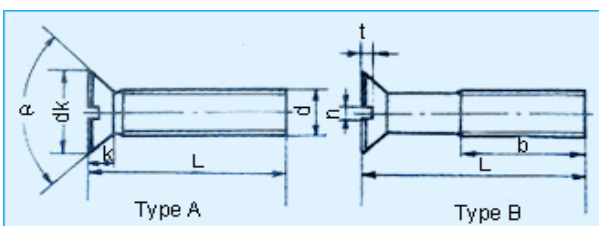

mm

Thread size	M3	M3.5	M4	M5	M6	M8	M10
dk	5.6	6.5	7.5	9.2	11	14.5	18
k	1.65	1.93	2.2	2.5	3	4	5
L	Type A	6-22	6-22	8-25	8-28	10-35	14-40
	Type B	25-30	25-35	28-40	30-50	40-60	45-80

SLOTTED RAISED COUNTERSUNK HEAD SCREWS

DIN 964

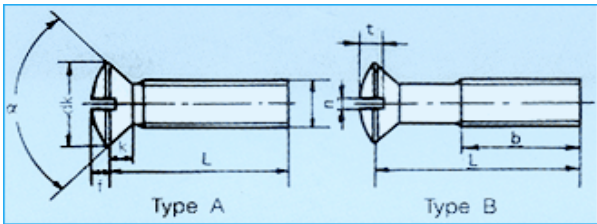

mm

Thread size	M3	M3.5	M4	M5	M6	M8	M10
dk	5.6	6.5	7.5	9.2	11	14.5	18
k	1.65	1.93	2.2	2.5	3	4	5
f	0.75	0.9	1	1.25	1.5	2	2.5
L	Type A	6-22	6-22	8-25	8-28	10-35	14-40
	Type B	25-30	25-35	28-40	30-50	40-60	45-80

GALVANIZED ROOFING BOLTS & NUTS

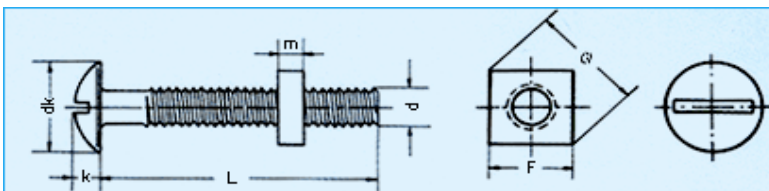

inches

Thread size	dk	k	m	F	G	L
3/6	10	2.3	3.048	8.128	11.684	3/16-3
1/4	13.3	3	0.302	11.176	16.002	1/2-5

ROOFING BOLTS & NUTS

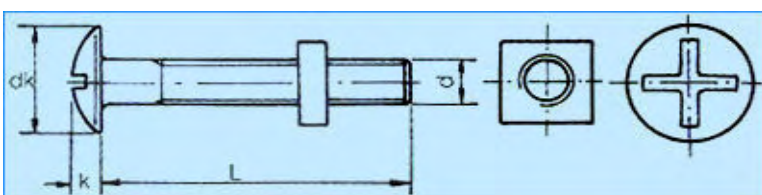

mm

Thread size	M4	M5	M6	M8
dk	9.4	11.6	13.95	18.9
k	1.90	2.65	3.33	3.80
L	10-50	10-80	12-120	16-150

CROSS RECESSED RAISED CHEESE HEAD SCREWS

DIN 7985

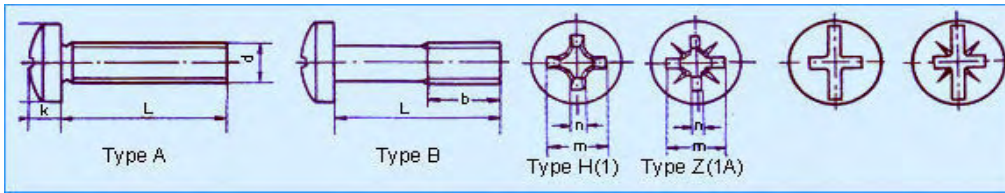

mm

Thread size	M3	M3.5	M4	M3	M6	M8	M10
dk	6	7	8	10	12	16	20
k	2.4	2.7	3.1	3.8	4.6	6	7.5
Cross recess	(Type H)m	3.1	4.2	4.6	5.3	6.8	10.2
	(Type Z)m	3	4	4.3	5	6.7	9.9
	No	1	2	2	2	3	4
L	Type A	6-22	6-22	8-25	8-28	10-35	14-40
	Type B	25-30	25-35	28-40	30-50	40-60	45-80

CROSS RECESSED COUNTERSUNK FLAT HEAD SCREWS

DIN 965

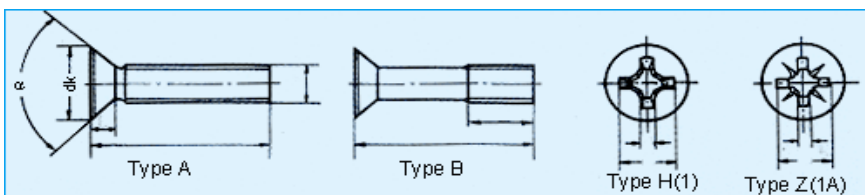

mm

Thread size	M3	M3.5	M4	M5	M6	M8	M10
dk	5.6	6.5	7.5	9.2	11	14.5	18
k	1.65	1.93	2.2	2.5	3	4	5
Cross	(Type H)m	2.9	3.9	4.4	4.6	6.6	9.6
	(Type Z)m	2.8	3.7	4	4.4	6.1	9.4
	No	1	2	2	2	3	4
L	Type A	6-22	6-22	8-25	8-28	10-35	14-40
	Type B	25-30	25-35	28-40	30-50	40-60	45-80

CROSS RECESSED RAISED COUNTERSUNK HEAD SCREWS

DIN 966

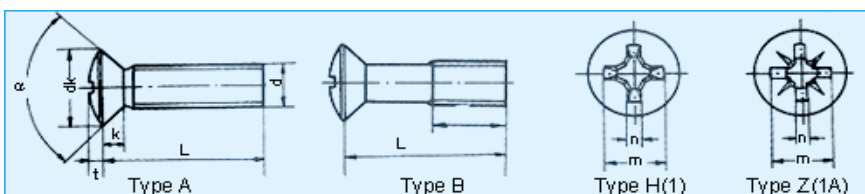

mm

Thread size	M3	M3.5	M4	M5	M6	M8	M10
dk	5.6	6.5	7.5	9.2	11	14.5	18
k	1.65	1.93	2.2	2.5	3	4	5
f	0.75	0.9	1	1.25	1.5	2	2.5
Cross	(Type H)m	3.1	4.2	4.5	5.3	6.8	10
	(Type Z)m	3.1	4.3	4.6	5.3	7	9.9
	NO	1	2	2	2	3	4
L	Type A	6-22	6-22	8-25	8-28	10-35	14-40
	Type B	25-30	25-35	28-40	30-50	40-60	45-80

SLOTTED COUNTERSUNK HEAD WOOD SCREWS

DIN 97

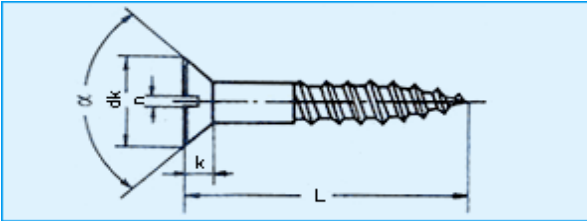

mm

Thread size	2.5	3	3.5	4	4.5	5	5.5	6
dk	4.7	5.6	6.5	7.5	8.3	9.2	10.2	11
k	1.5	1.65	1.93	2.2	2.35	2.5	2.75	3
n	0.6	0.8	0.8	1	1	1.2	1.2	1.6
L	8-25	10-40	12-40	16-50	20-60	20-100	30-100	40-100

SLOTTED RAISED COUNTERSUNK HEAD WOOD SCREWS

DIN 95

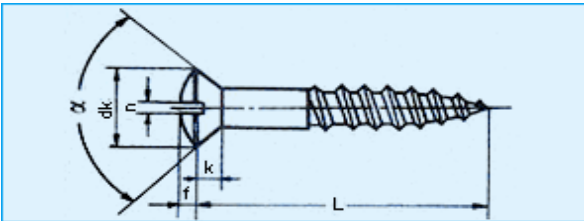

mm

Thread size	2.5	3	3.5	4	4.5	5	5.5	6
dk	4.7	5.6	6.5	7.5	8.3	9.2	10.2	11
f	0.6	0.75	0.9	1	1.1	1.25	1.4	1.5
k	1.5	1.65	1.93	2.2	2.35	2.5	2.75	3
n	0.6	0.8	0.8	1	1	1.2	1.2	1.6
L	8-25	10-40	12-40	16-50	20-60	20-100	30-100	40-100

SLOTTED ROUND HEAD WOOD SCREWS

DIN 96

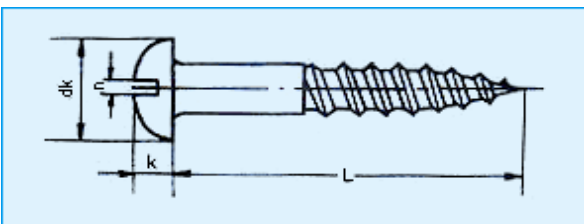

mm

Thread size	2.5	3	3.5	4	4.5	5	5.5	6
dk	5	6	7	8	9	10	11	12
K	1.7	2.1	2.4	2.8	3.1	3.5	3.8	4.2
n	0.6	0.8	0.8	1	1	1.2	1.2	1.6
L	8-25	10-40	12-40	16-50	20-60	20-100	30-100	40-100

FLAT COUNTERSUNK HEAD WOOD SCREWS

DIN 7997

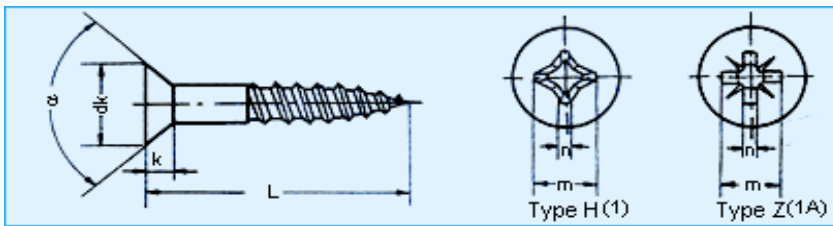

mm

Thread size	2.5	3	3.5	4	4.5	5	5.5	6
dk	4.7	5.6	6.5	7.5	8.3	9.2	10.2	11
k	1.5	1.65	1.93	2.2	2.35	2.5	2.75	3
Cross recess	(Type H) m	2.7	2.9	3.9	4.4	4.6	6.2	6.6
	(Type Z) m	2.8	3	4	4.2	4.4	5	6.3
	No	1	1	2	2	2	3	3
L	10-25	10-40	12-45	16-50	20-60	20-100	30-100	40-100

CROSS RECESSED ROUND HEAD WOOD SCREWS

DIN 7996

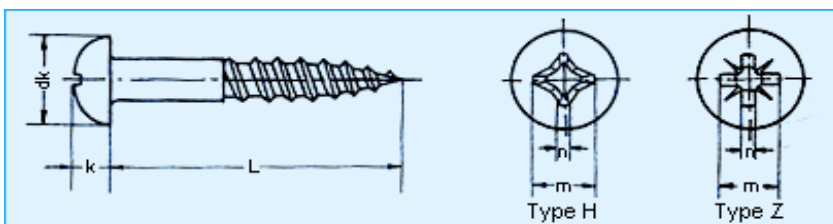

mm

Thread size	2.5	3	3.5	4	4.5	5	5.5	6
dk	5	6	7	8	9	10	11	12
k	1.7	2.1	2.35	2.8	3.1	3.5	3.8	4.2
Cross	(Type H) m	2.3	2.7	3.7	4.1	4.4	6.2	6.6
	(Type Z) m	2.4	2.9	3.9	4.1	4.3	4.7	6.7
	No	1	1	2	2	2	3	3
L	10-25	10-40	12-40	16-50	20-60	20-100	30-100	40-100

CROSS RECESSED RAISED COUNTERSUNK HEAD WOOD SCREWS

DIN 7995

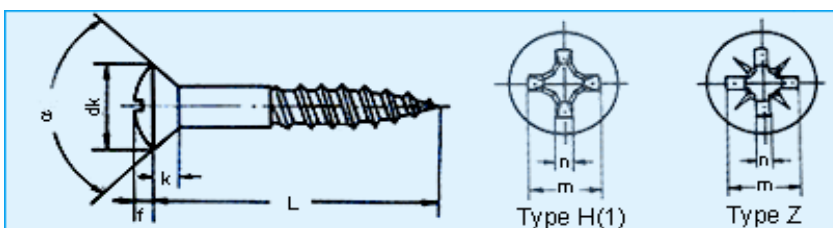

mm

Thread size	2.5	3	3.5	4	4.5	5	5.5	6
dk	4.7	5.6	6.5	7.5	8.3	9.2	10.2	11
f	0.6	0.75	0.9	1	1.1	1.25	1.4	1.5
k	1.5	1.65	1.93	2.2	2.35	2.5	2.75	3
Cross	(Type H) m	2.7	3.1	4.2	4.5	5	7.1	7.4
	(Type Z) m	2.8	3.1	4.3	4.6	5.1	6.6	7
	No	1	1	2	2	2	3	3
L	10-25	10-40	12-40	16-50	20-60	20-100	30-100	40-100

PHILLIPS OVAL HEAD WOOD SCREWS

B.S. 1210

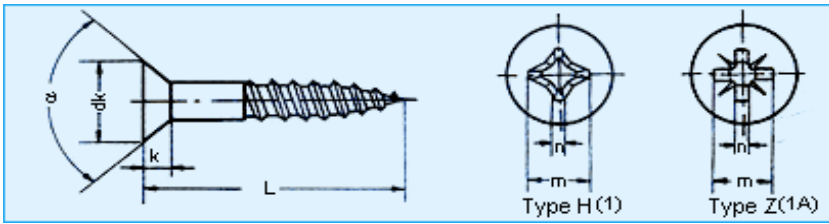

inches

Thread size	4	5	6	7	8	9	10
dk	5.21	5.90	6.58	7.24	7.93	8.59	9.28
f	0.66	0.76	0.81	0.91	1.02	1.17	1.19
k	1.62	1.85	2.08	2.31	2.54	2.76	2.97
Cross recess	(Type Z) m	3.12	3.81	4.32	4.65	5.00	5.28
	NO	1	1	2	2	2	2
L	1/2-1	1/2-1 1/4	1/2-2	3/4-2	3/4-3	3/4-3	3/4-3 1/2

CROSS RECESSED COUNTERSUNK HEAD WOOD SCREWS

B.S. 1210

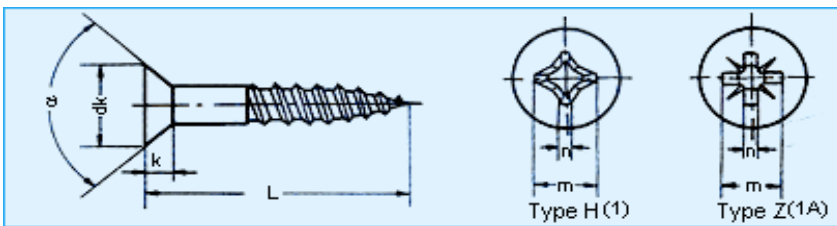

inches

Thread size	3	4	5	6	7	8	9	10	12	14	16
dk	4.55	5.21	5.90	6.56	7.24	7.93	8.59	9.28	10.62	11.99	13.31
k	1.39	1.62	1.88	2.08	2.31	2.54	2.76	2.97	3.42	3.88	4.31
(Type Z) m	2.51	2.74	3.50	4.22	4.22	4.60	4.60	4.98	6.35	6.60	7.49
Cross recess No	1	1	2	2	2	2	2	2	3	3	3
L	1/2-5/8	1/2-2	1/2-1 1/4	1/2-2	3/4-2	3/4-3	3/4-3	3/4-3 1/2	1-5	1 1/2-5	1 1/2-5

EURO SCREW

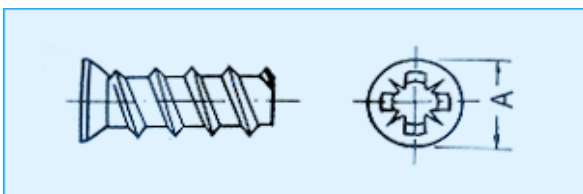

mm

Nominal size	6.3	6.3
Length	9-13	9-13
A	7	8

CONNECTING SCREW FLAT COUNTERSUNK HEAD

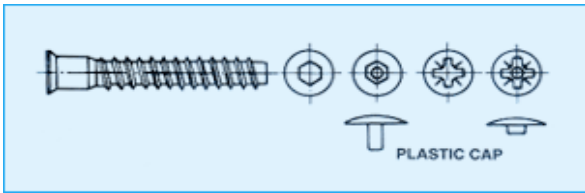

mm

Nominal size	5	7	6.3
Length	40-60	40-80	40-80

JOINT CONNECTOR SCREW FLAT HEAD

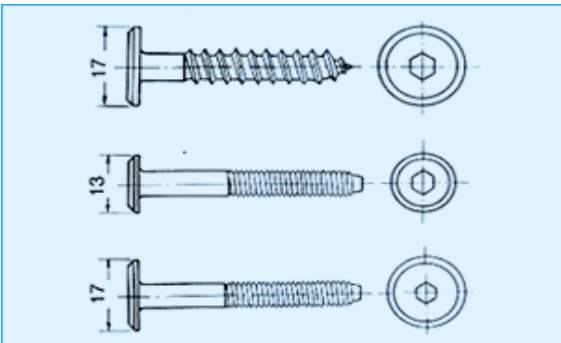

Nominal size	M6-1.0	1/4-20	6.3
Length	20-120	20-120	20-120

JOINT CONNECTOR SCREW ROUND HEAD

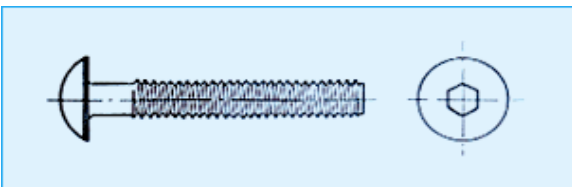

Nominal size	M6-1.0	1/4-20
Length	20-120	20-120

HEXAGON HEAD WOOD SCREWS

DIN 571

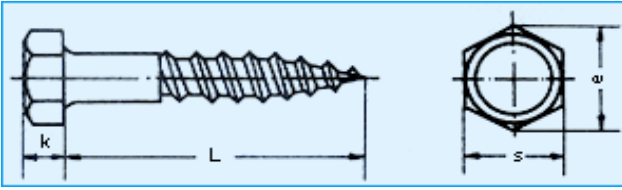

mm

Thread size	4	5	6	7	8	10	12	16
k	2.8	3.5	4	5	5.5	7	8	10
e	7.50	8.63	10.89	13.07	14.2	18.72	20.88	26.17
s	7	8	10	12	13	17	19	24
L	16-40	16-50	25-150	30-150	30-200	30-300	35-400	50-420

ACOUSTICALLY EYE LAGS

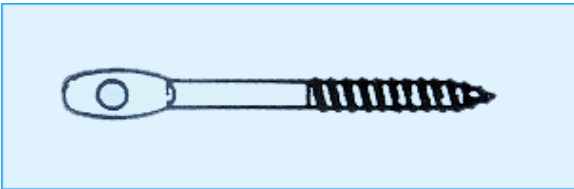

inches

Nominal size	1/4 x 3"	1/4 x 4"	1/4 x 5"

METAL WOOD DOWEL SCREW

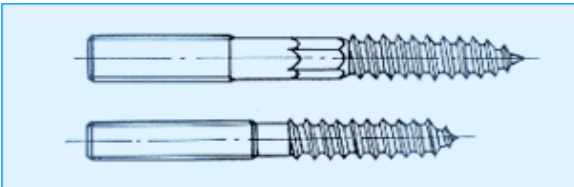

mm

Nominal size	M8-12
Length	50-200

WOOD-WOOD DOWEL SCREW

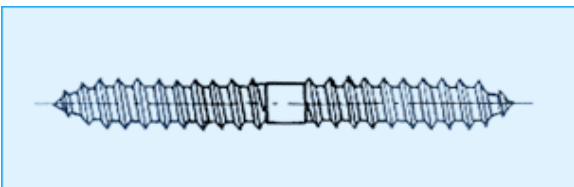

Nominal size	3.5-6.3
Length	25-80

POZIDRIVE TWINFAST WOOD SCREWS

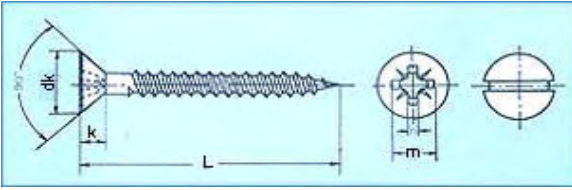

mm

Thread size	4	5	6	7	8	10	12
dk	5.48	6.19	6.90	7.62	8.33	9.75	11.17
k	1.66	1.90	2.13	2.36	2.53	3.01	3.44
n	0.86	1.06	1.06	1.06	1.26	1.26	1.66
cross recess	No	1	2	2	2	2	3
	m	2.74	3.50	4.22	4.22	4.60	4.98
L(in)	1/4-1	5/16-11/4	7/16-2	1/2-21/4	5/8-3	3/4-4	1-4

PAN HEAD TAPPING SCREWS WITH SLOT

DIN 7971

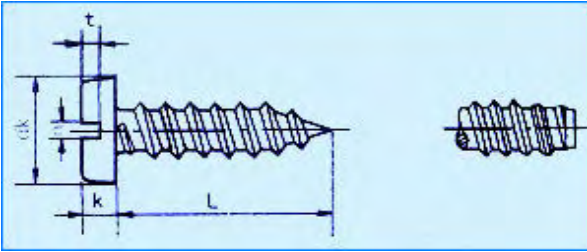

mm

Thread size	2.9	3.5	3.9	4.2	4.8	5.5	6.3
dk	5.6	6.9	7.5	8.2	9.5	10.8	12.5
k	1.5	1.85	2	2.15	2.5	2.85	3.2
m	0.8	1	1	1.2	1.2	1.6	1.6
L(mm)	6.5-25	6.5-50	9.5-50	9.5-63	9.5-63	13-75	13-75

COUNTERSUNK HEAD TAPPING SCREWS WITH SLOT

DIN 7972

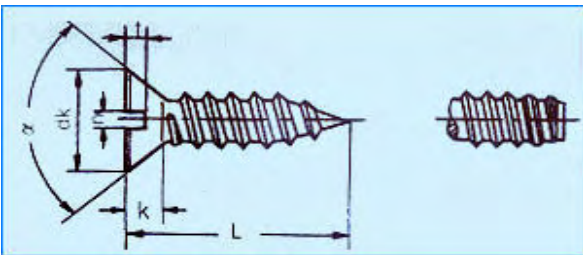

mm

Thread size	2.9	3.5	3.9	4.2	4.8	5.5	6.3
dk	5.5	6.8	7.5	8.1	9.5	10.8	12.4
k	1.7	2.1	2.3	2.5	3	3.4	3.8
n	0.8	1	1	1.2	1.2	1.6	1.6
L	6.5-25	6.5-50	9.5-50	9.5-63	9.5-63	13-75	13-75

RAISED COUNTERSUNK HEAD TAPPING SCREWS WITH SLOT

DIN 7973

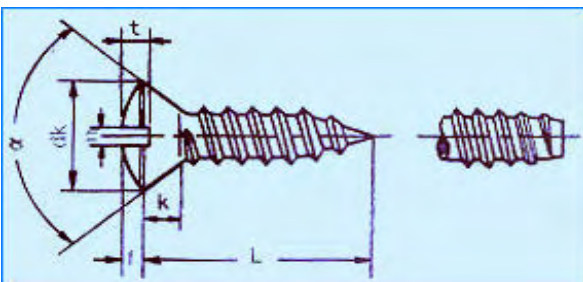

mm

Thread size	2.9	3.5	3.9	4.2	4.8	5.5	6.3
dk	5.5	6.8	7.5	8.1	9.5	10.8	12.5
f	0.9	1.2	1.3	1.4	1.5	1.7	2
k	1.7	2.1	2.3	2.5	3	3.4	3.8
n	0.8	1	1	1.2	1.2	1.6	1.6
L	6.5-25	6.5-50	9.5-50	9.5-63	9.5-63	13-75	13-75

SELF-DRILLING TAPPING SCREWS

DIN 7504

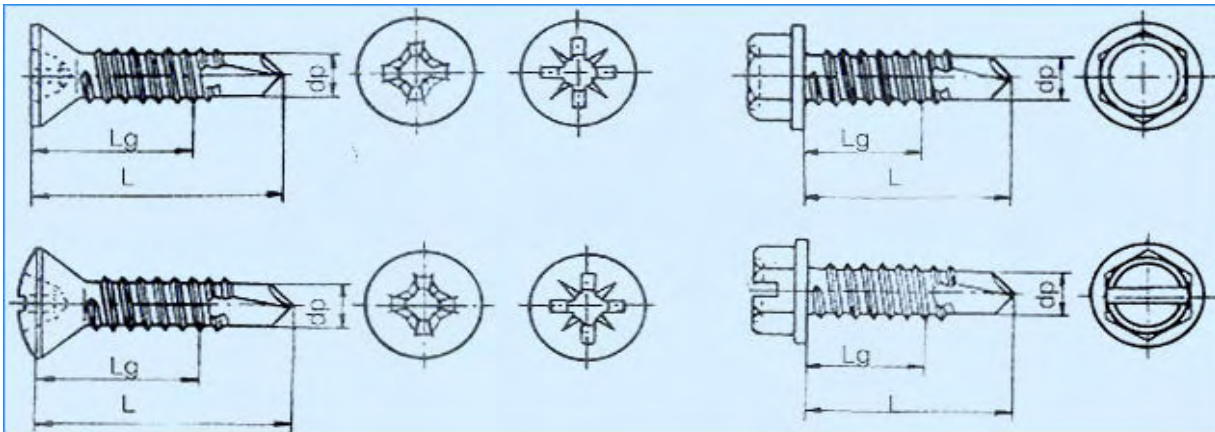

mm

Thread size	ST2.9	ST3.5	ST4.2	ST4.8	ST5.5	ST6.3
dp	2.3	2.8	3.6	4.1	4.8	5.8
Lg	6.6-12.5	6.2-18.1	4.3-29.0	5.8-39.5	8-39	7-38
L	6.5-25	6.5-50	9.5-50	9.5-63	13-75	13-75

CROSS RECESSED COUNTERSUNK HEAD TAPPING SCREWS

DIN 7982

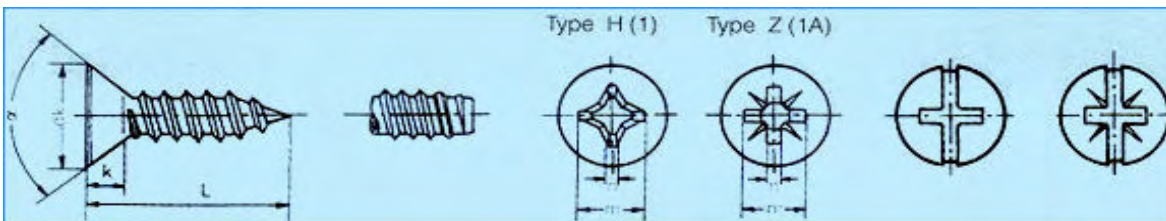

mm

Thread size	2.9	3.5	3.9	4.2	4.8	5.5	6.3
dk	5.5	6.8	7.5	8.1	9.5	10.8	12.4
k	1.7	2.1	2.3	2.5	3	3.4	3.8
Cross recess	(Type H) m	3	4.2	4.6	4.7	5.1	5.8
	(Type Z) m	2.8	4	4.2	4.4	5	6.3
	No	1	1	2	2	2	3
L	6.5-25	6.5-50	9.5-50	9.5-63	9.5-63	13-75	13-75

CROSS RECESSED PAN HEAD TAPPING SCREWS

DIN 7981

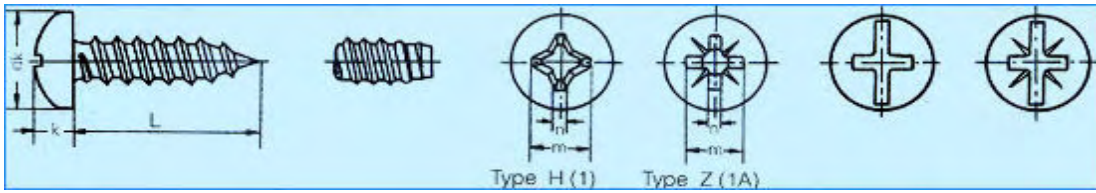

mm

Thread size	2.9	3.5	3.9	4.2	4.8	5.5	6.3
Pitch	5.6	6.9	7.5	8.2	9.5	10.8	12.5
k	2.2	2.6	2.8	3.05	1.55	3.95	4.55
Cross recess	(Type H)m	3	4.2	4.4	4.6	5	6.5
	(Type Z)m	2.9	3.9	4.1	4.3	4.7	6.2
	No	1	1	2	2	3	3
L	6.5-25	6.5-50	9.5-50	9.5-63	9.5-63	13-75	13-75

CROSS RECESSED RAISED COUNTERSUNK HEAD TAPPING SCREWS

DIN 7983

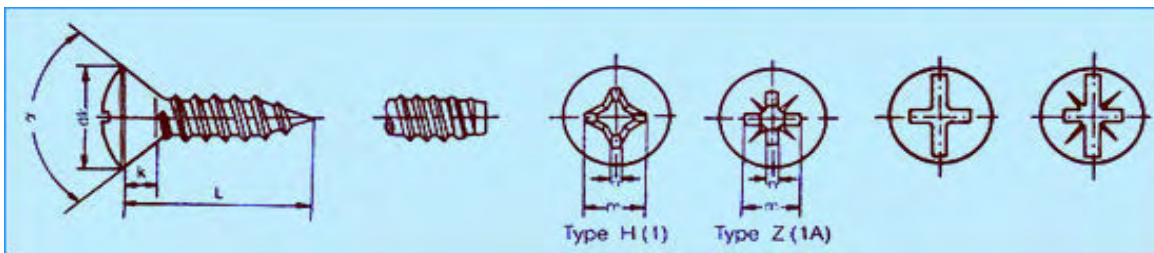

mm

Thread size	2.9	3.5	3.9	4.2	4.8	5.5	6.3
dk	5.5	6.8	7.5	8.1	9.5	10.8	12.4
f	0.9	1.2	1.3	1.4	1.5	1.7	2
k	1.7	2.1	2.3	2.5	3	3.4	3.8
Cross	(Type H) m	3.4	4.6	4.7	4.9	5.4	7
	(Type Z) m	3.1	4.3	4.4	4.6	5.1	6.6
	No	1	1	2	2	2	3
L	6.5-25	6.5-50	9.5-50	9.5-63	9.5-63	13-75	13-75

CROSS RECESSED PAN HEAD TAPPING SCREWS WITH COLLAR

DIN 968

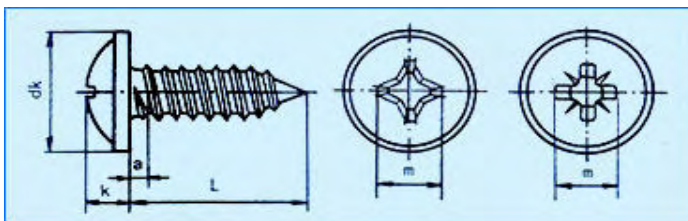

mm

Thread size	ST2.9	ST3.5	ST4.2	ST4.8	ST5.5	ST6.3
dk	7.50	9.00	10.0	11.5	13.0	14.5
k	2.35	2.60	3.05	3.55	3.80	4.55
Cross	(Type H) m	3.00	4.20	4.60	5.00	6.50
	(Type Z) m	2.90	3.90	4.30	4.70	6.20
	No	1	2	2	2	3
L	6.5-19	9.5-25	9.5-32	9.5-50	13-50	13-50

DRYWALL SCREWS TYPE S PHILLIPS RECESSED BUGLE HEAD TWINFAST

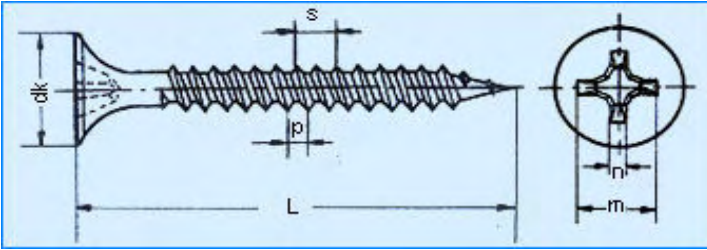

Thread size	Threads/in	dk	Cross recess		L(in)
			No	m	
6	18	8.4	2	4.9	3/4-2 1/2
7	16	8.4	2	4.9	1-2 1/2
8	15	8.4	2	4.9	2-4

FERMACELL SCREWS WITH RIBS UNDER THE HEAD



HEXAGON WASHER HEAD TAPPING SCREWS

DIN 6928

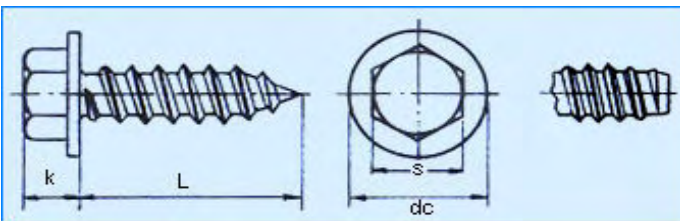

mm

Thread size	ST2.9	ST3.5	ST4.2	ST4.8	ST6.3	ST8.0
dc	6.30	8.30	8.80	10.5	13.5	18.0
k	2.80	3.40	4.0	4.30	5.90	7.00
s	4.00	5.50	7.00	8.00	10.0	13.0
L	6.5-25	6.5-50	9.5-50	9.5-63	13-75	13-75

HEX HEAD TAPPING SCREWS

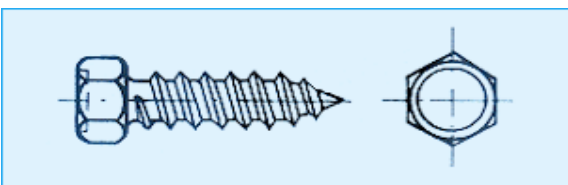

Nominal size	4.2	4.8	5.5	6.3	8 [#]	10 [#]	12 [#]	1/4
Length	9.5-50	13-75	16-100	16-120	3/8-2	1/2-3	3/4-4	3/4-5

HEX FLANGE HEAD SELF-TAPPING SCREWS

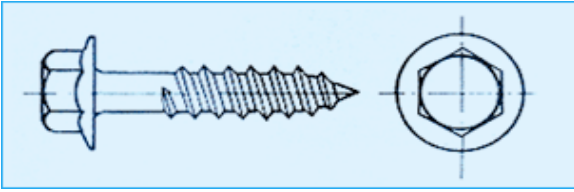

Nominal	5.5	6.3	12[#]	14[#]
Length	16-120	16-180	16-120	16-180

HEX FLANGE HEAD TYPE 17 SCREWS

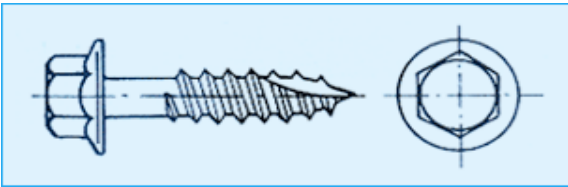

Nominal	12[#]	1/4	5.5	6.3
Length	1-5	1 1/2-5	25-120	30-120

THREADED ROD

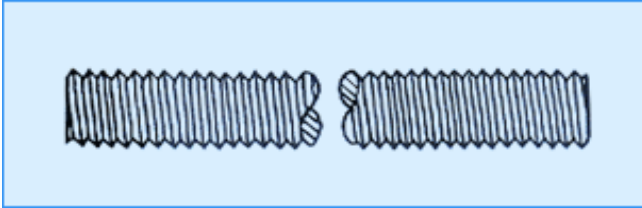

mm

Thread size	M6	M8	M10	M12	M14	M16	M18	M20	M22	M24
LENGTH	1000mm-40000mm									

inches

Thread size	1/4	5/16	3/8	7/16	1/2	9/16	5/8	3/4	7/8	1
LENGTH	3feet-12feet									

WIRE ROPE CLAMPS

DIN 741

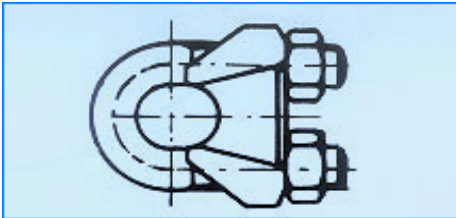

mm

for rope dia	3	5	6.5	8	10	11	13	14	16
Thread size	M4	M5	M5	M6	M8	M8	M10	M10	M12

HEX HEAD PIPE PLUGS

DIN 910

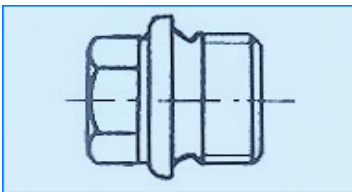

Thread size	M10	M12	M14	M16	M18	M20	M22	M24	M26	M30	M36
-------------	-----	-----	-----	-----	-----	-----	-----	-----	-----	-----	-----

STEEL PIPE SCAFFOLD

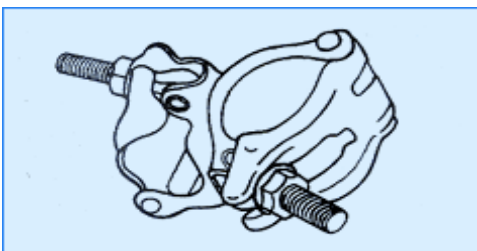

CHINA

GREASE FITTING

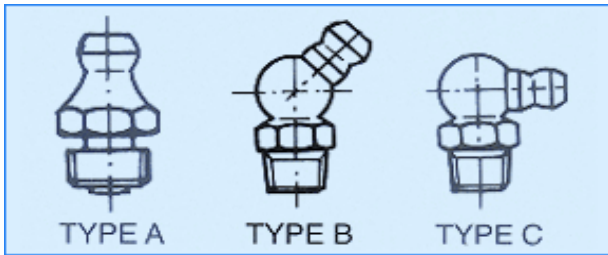

mm

Thread size	6×1	8×1	8×1.2	10×1